

Marigold, Stage 6

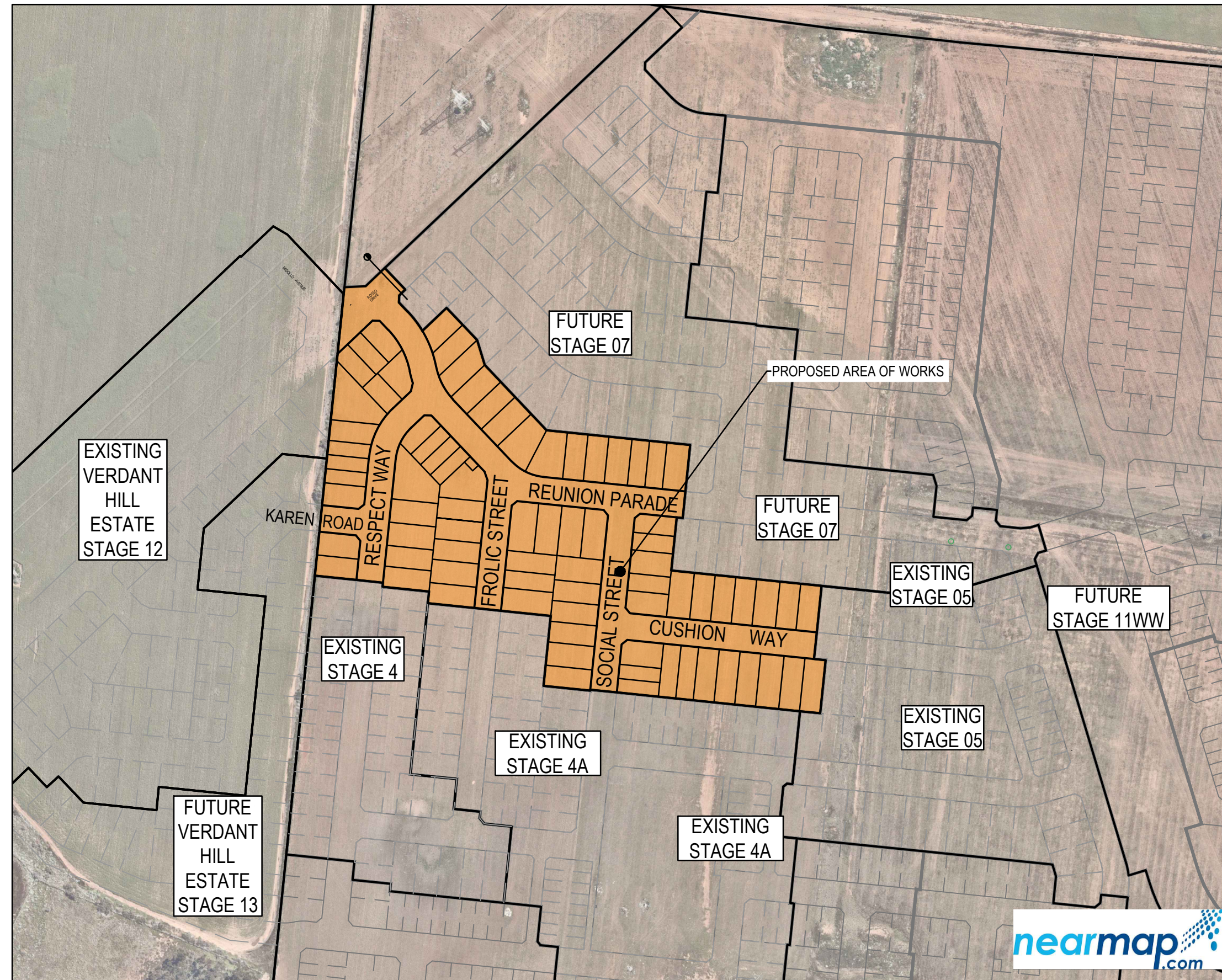

TBM SETOUT TABLE				
POINT	EAST	NORTHING	ELEVATION	DESCRIPTION
C1RVCT 1	311,726.94	5,818,242.85	44.23	RIVET IN CONCRETE
C1RVCT 2	311,726.94	5,818,242.85	44.23	RIVET IN CONCRETE
C1RVCT 3	311,726.94	5,818,242.85	44.23	RIVET IN CONCRETE
C1RVCT 4	311,726.94	5,818,242.85	44.23	RIVET IN CONCRETE
C1RVCT 5	311,726.94	5,818,242.85	44.23	RIVET IN CONCRETE
C1RVCT 6	311,726.94	5,818,242.85	44.23	RIVET IN CONCRETE

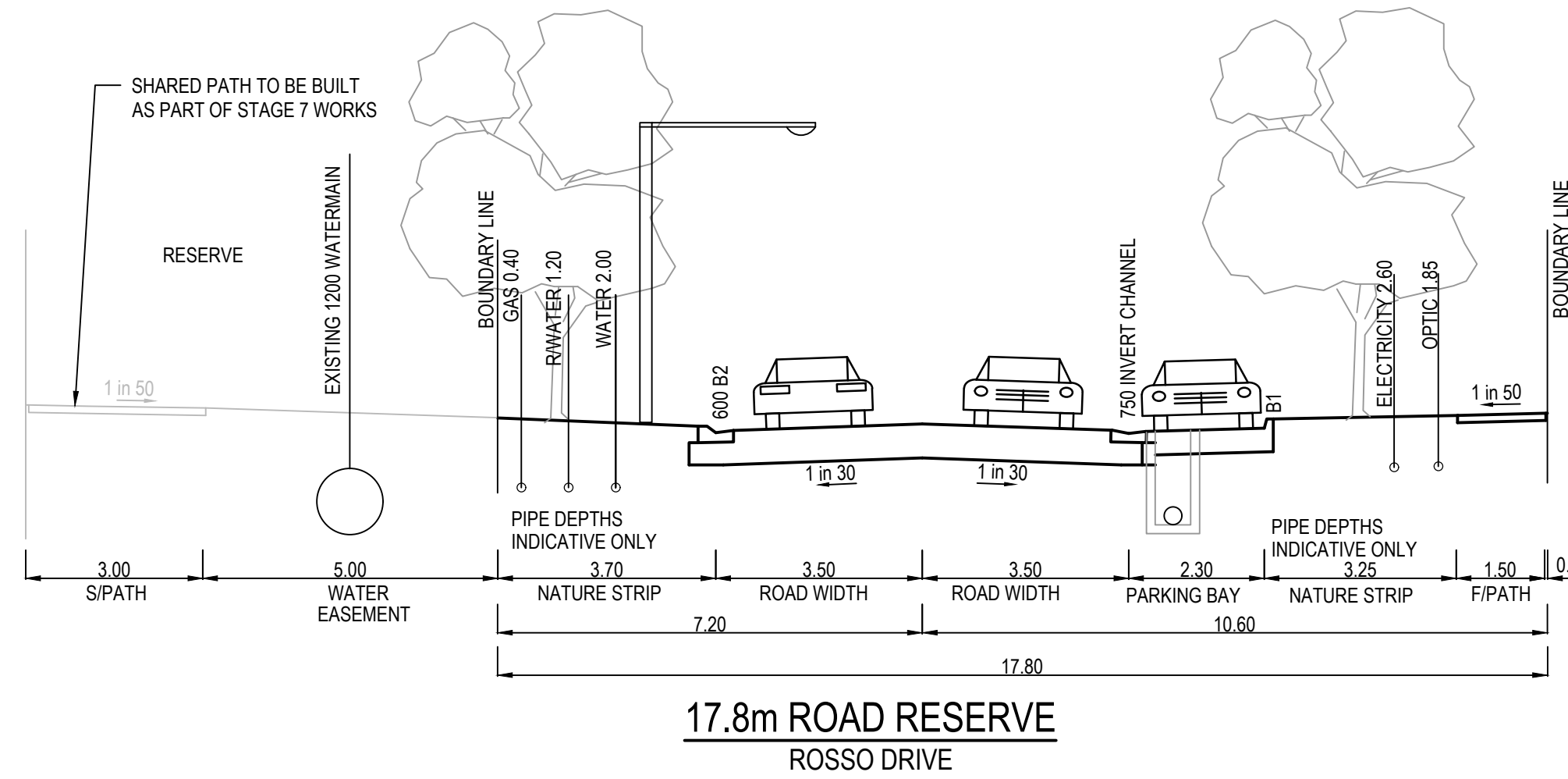

Drawing Index

- 2360E-006-101 Cover Plan & General Notes
- 2360E-006-111 Layout Plan - 1
- 2360E-006-112 Layout Plan - 2
- 2360E-006-131 Earthworks Setout Plan
- 2360E-006-171 Signage & Linemarking Plan
- 2360E-006-181 Intersection Detail Plan - 1
- 2360E-006-182 Intersection Detail Plan - 2
- 2360E-006-183 Intersection Detail Plan - 3
- 2360E-006-201 Longitudinal Sections - 1
- 2360E-006-202 Longitudinal Sections - 2
- 2360E-006-203 Longitudinal Sections - 3
- 2360E-006-251 Cross Sections: Cushion Way
- 2360E-006-252 Cross Sections: Frolic Street
- 2360E-006-253 Cross Sections: Karen Road & Rosso Drive
- 2360E-006-254 Cross Sections: Respect Way
- 2360E-006-255 Cross Sections: Reunion Parade Ch 264.02- Ch 389.58
- 2360E-006-256 Cross Sections: Reunion Parade Ch 403.58- Ch 497.76
- 2360E-006-257 Cross Sections: Social Street
- 2360E-006-301 Drainage Longitudinal Sections - 1
- 2360E-006-302 Drainage Longitudinal Sections - 2
- 2360E-006-303 Drainage Longitudinal Sections - 3
- 2360E-006-351 Pit Schedule
- 2360E-006-411 Pavement Details
- 2360E-006-421 General Details
- 2360E-006-500 Safety In Design

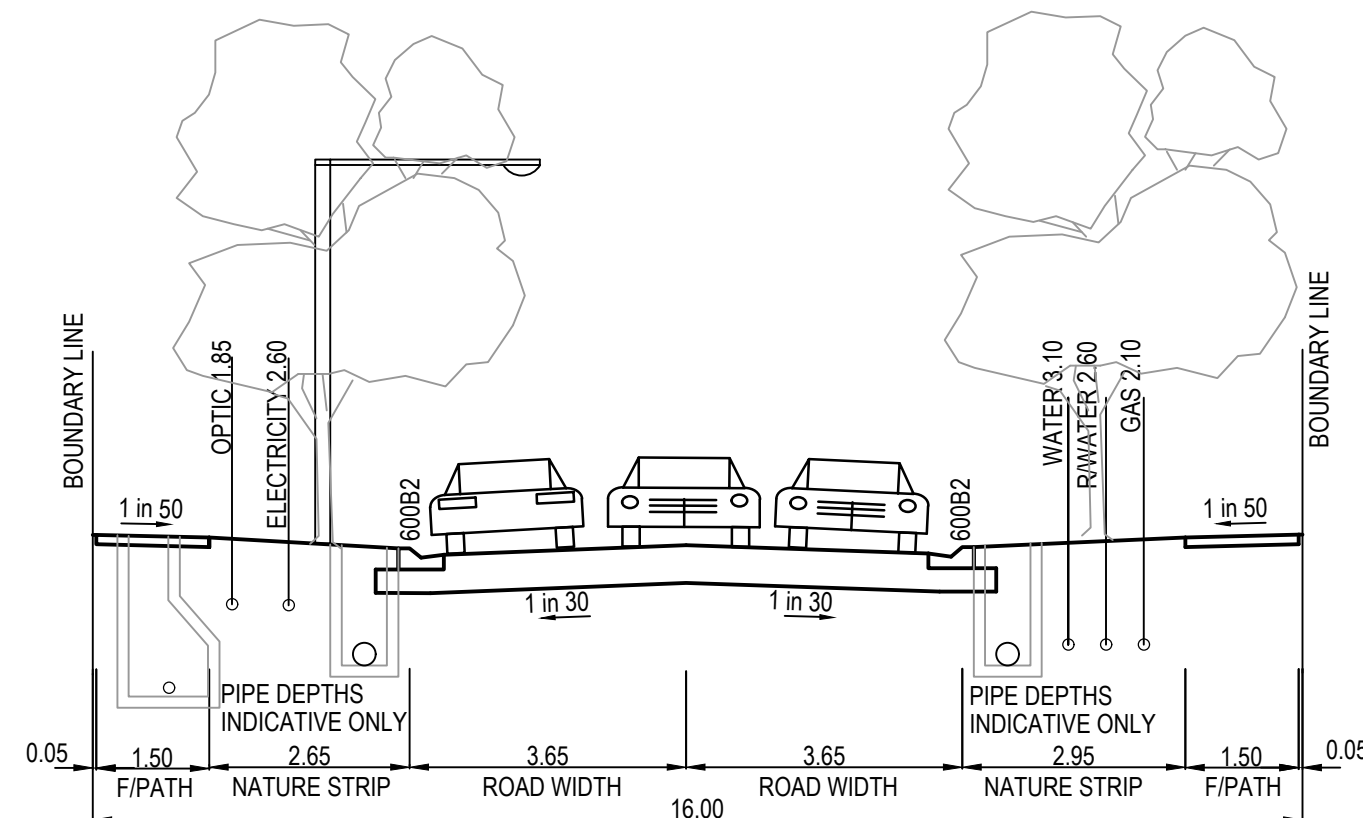

16m ROAD RESERVE
RESPECT WAY, FROLIC STREET AND
CUSHION WAY

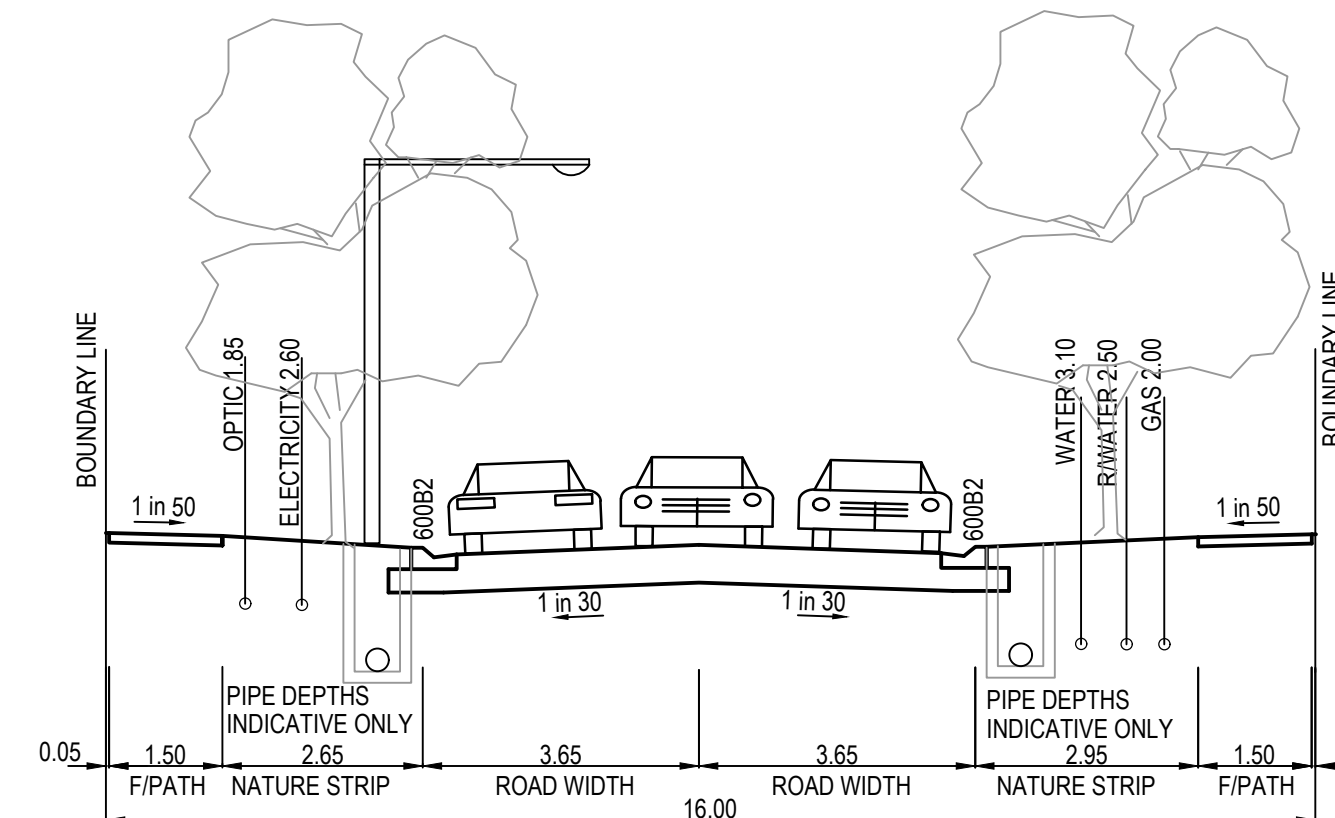

16m ROAD RESERVE
SOCIAL STREET

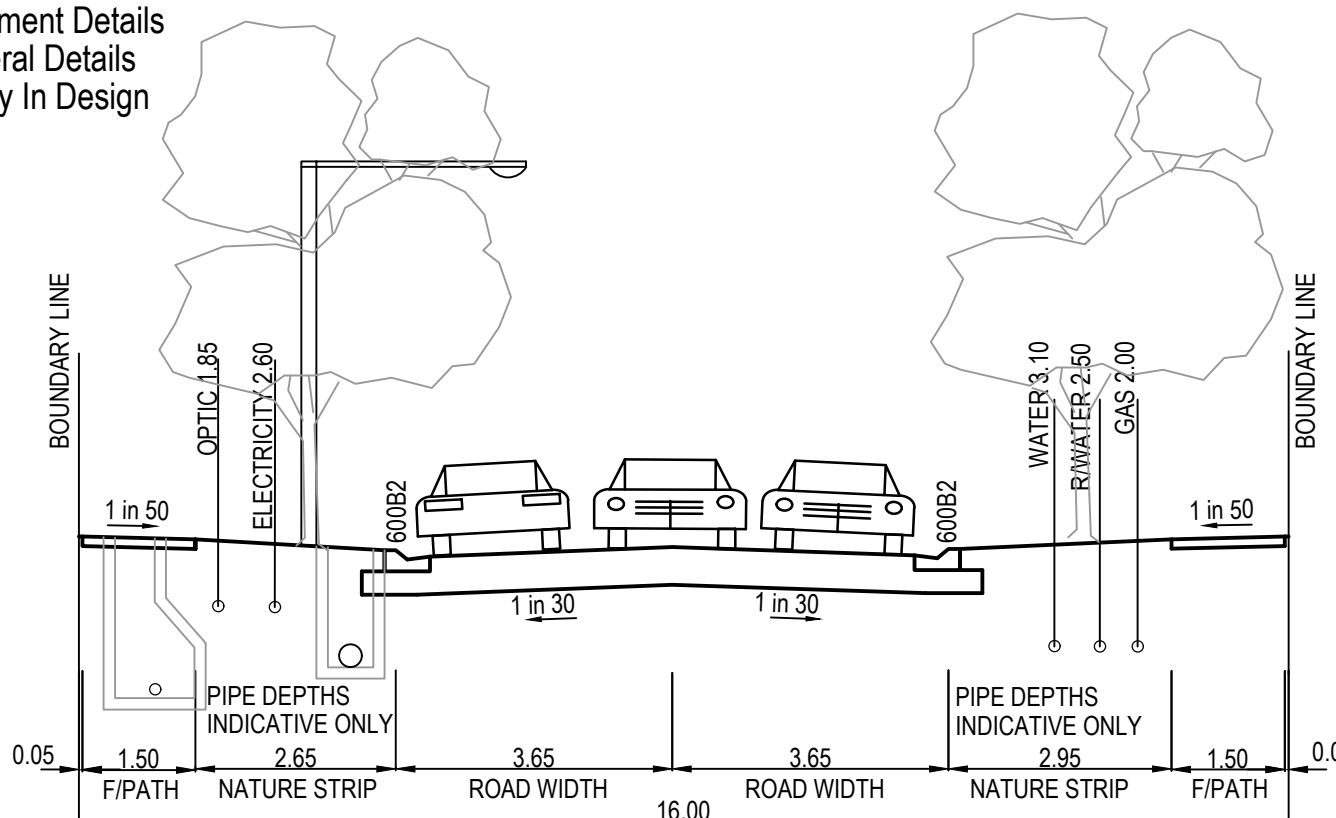

16m ROAD RESERVE
REUNION PARADE

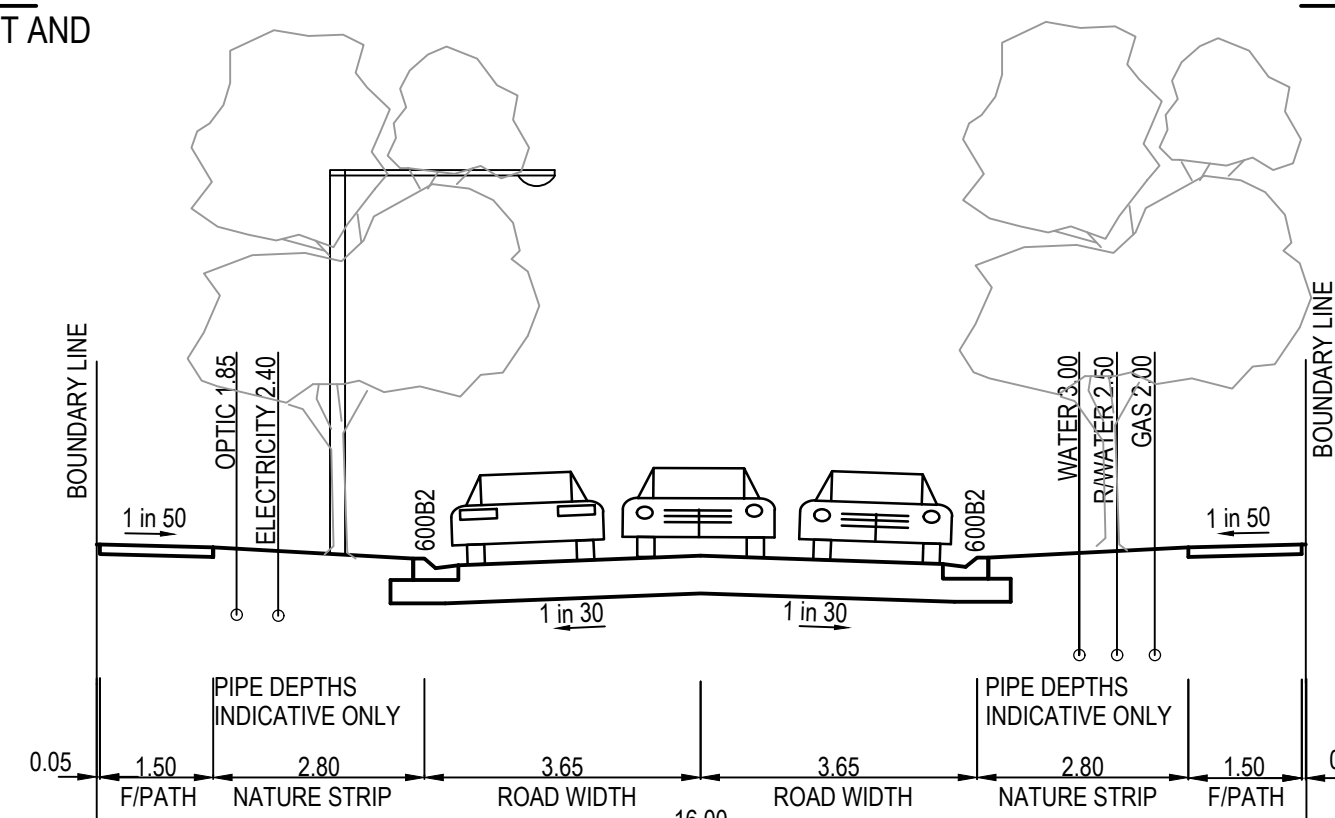

16m ROAD RESERVE
KAREN ROAD

These designs and drawings are the copyright of SMEC Australia Pty Ltd. The drawing shall not be reproduced or copied, in whole or part, without the written permission of SMEC Australia Pty Ltd. The contents of this drawing are electronically generated, are confidential and may only be used for the purpose for which they are intended.

GENERAL NOTES (WYNDHAM CITY COUNCIL)

1. THE WORKS SHALL BE CONSTRUCTED IN ACCORDANCE WITH THE CURRENT EDM ADDENDUM STANDARD DRAWINGS AND SPECIFICATIONS. WORKS TO BE CARRIED OUT TO THE SATISFACTION OF COUNCIL'S SUPERVISING OFFICER.
2. THE CONTRACTOR IS RESPONSIBLE FOR SAFETY OF WORK ON SITE IN ACCORDANCE WITH APPROPRIATE LEGISLATION. THE CONTRACTOR SHALL ERECT AND MAINTAIN ALL SHORING, PLANKING AND STRUTTING, DEWATERING DEVICES, BARRICADES, SIGNS, LIGHTS, ETC. NECESSARY TO KEEP WORKS IN A SAFE AND STABLE CONDITION, AND TO PROTECT THE PUBLIC FROM HAZARDS ASSOCIATED WITH THE WORKS.
3. THE CONTRACTOR SHALL:
 - 3.1. COMPLY WITH THE SAFETY REQUIREMENTS OF THE MINES ACT, GENERAL REGULATIONS AND STATUTORY RULES AND THE MINES (TRENCHES) REGULATIONS 1982.
 - 3.2. NOTIFY THE OCCUPATIONAL HEALTH AND SAFETY AUTHORITY OF THEIR INTENTION TO COMMENCE TRENCHING OPERATIONS WHERE TRENCHES ARE 1.5 METRES OR DEEPER.
 - 3.3. ENSURE THAT THE MINE MANAGER OR THEIR DEPUTY AS REQUIRED BY THE REGULATIONS IS IN ATTENDANCE WHEN TRENCHING OPERATIONS ARE IN PROGRESS.
4. THE CONTRACTOR IS TO NOTIFY COUNCIL AND ALL SERVICE AUTHORITIES SEVEN (7) DAYS PRIOR TO COMMENCEMENT OF CONSTRUCTION.
5. THE LOCATION OF EXISTING SERVICES SHOULD BE DETERMINED BY THE CONTRACTOR PRIOR TO COMMENCING ANY EXCAVATION BY CONTACTING ALL RELEVANT SERVICE AUTHORITIES. ANY EXISTING SERVICES SHOWN ON THE DRAWINGS ARE OFFERED AS A GUIDE ONLY AND ARE NOT GUARANTEED AS CORRECT.
6. TREES MARKED ON THE APPROVED PLANS FOR REMOVAL MUST BE REMOVED FROM THE SITE PRIOR TO THE COMMENCEMENT OF WORKS. NO EXCAVATION SHALL BE CARRIED OUT WITHIN 5.0m OF ANY EXISTING TREE UNTIL APPROVAL HAS BEEN GIVEN BY COUNCIL'S SUPERVISING OFFICER.
7. ALL ROAD CHAINAGES ARE MEASURED ALONG THE ROAD CENTRELINE EXCEPT KERB RETURNS AND COURTHEDS, WHERE LIP OF KERB CHAINAGES ARE SPECIFIED. ALL DIMENSIONS AND RADII ARE GIVEN TO THE LIP OF KERB. DO NOT SCALE OFF THESE DRAWINGS. WRITTEN DIMENSIONS ONLY SHALL BE USED.
8. CONDUIT LOCATIONS ARE SUBJECT TO AMENDMENT AND CONDUITS SHALL NOT BE LAID UNTIL WRITTEN APPROVAL IS GIVEN BY THE SUPERINTENDENT. BOTH KERBS ARE TO BE MARKED WITH THE LETTERS E.G.H.R.T&W ABOVE CONDUIT LOCATIONS AS SPECIFIED. RESPECTIVE LETTERS TO BE INDICATED ABOVE RELEVANT CONDUITS AS PER STANDARD DRAWING EDM 303. CONDUITS TO BE PLACED MINIMUM OF 5m FROM BOUNDARIES WHERE POSSIBLE AND TO THE SATISFACTION OF THE SUPERINTENDENT IN ACCORDANCE WITH COUNCIL STANDARD DRAWINGS.
9. SUBSOIL DRAINS SHALL BE INSTALLED BEHIND OR BELOW ALL KERB AND CHANNEL AS PER STANDARD DRAWINGS EDM 202 (EXPANSIVE SUBGRADE).
10. ALL LINEMARKING, SIGNING AND TRAFFIC CONTROL DEVICES TO BE IN ACCORDANCE WITH VICROADS REQUIREMENTS WITH LATERAL WORKS AND ARROWS BEING COLD APPLIED PLASTIC TROWELLED INTO PLACE (MATERIAL DEGAOUR OR PLASTELINE) AND LONGITUDINAL LINES BEING EXTRUDED THERMOPLASTIC MATERIAL (VICROADS SPECIFICATION SEE SECTION 710&722).
11. ALL LEVELS ARE TO AUSTRALIAN HEIGHT DATUM.
12. THE CONTRACTOR WHEN ENGAGED IN BLASTING OPERATION, SHALL NOT BLAST WITHIN 4.5m OF AN EXISTING LINE OF WATER, GAS OR SEWER PIPES OR WITHIN 15m OF ANY COMPLETED PART OF THE WORKS WITHOUT THE CONSENT OF THE ENGINEER.
13. ALL EXCAVATED OR FILLED AREAS OUTSIDE THE ROAD RESERVES SHALL BE SURFACED WITH A 100mm MINIMUM TO 200mm MAXIMUM LAYER OF TOPSOIL AS SPECIFIED. ALL FILLING ON ALLOTMENTS TO BE COMPACTED TO 95% STANDARD COMPACTION IN 150mm LAYERS AND AS PER THE SPECIFICATION. WHERE THERE IS FILL IN EXCESS OF 300mm IN DEPTH, THE CONTRACTOR IS TO CARRY OUT SOIL TESTS TO THE REQUIREMENTS OF APPENDIX B AS SPECIFIED IN THE AUSTRALIAN STANDARD AS 3798 TO SHOW THAT LEVEL 1 COMPACTION STANDARDS HAVE BEEN ACHIEVED. TEST RESULTS AND LOCATION OF TESTS FOR EACH ALLOTMENT SHALL BE APPROVED BY THE CONTRACTOR AND FORWARDED TO COUNCIL.
14. FILL MATERIAL USED UNDER PAVEMENTS AND FOOTPATHS MUST BE AN APPROVED MATERIAL TO THE STANDARD OF WYNDHAM CITY COUNCIL. ALL SUCH MATERIAL IS TO BE COMPACTED AS PER THE REQUIREMENTS OF THE SPECIFICATION APPROVED WITH THESE DRAWINGS PRIOR TO FORMWORK BEING PLACED. COMPACTION TESTS TO BE COMPLETED AND PROVIDED TO SUPERINTENDENT.
15. FILL & CUT BATTERS ARE NOT TO EXCEED 1 IN 6 SLOPE, UNLESS SHOWN OTHERWISE.
16. ALL ALLOTMENTS SHALL BE SMOOTHED, GRADED AND SHAPED TO AN EVEN SURFACE WITH A MINIMUM FALL OF 1 IN 150 TO THE DRAINAGE OUTLET SHOWN.
17. ALL DRAINAGE PIPES ARE CLASS 2 RCP PIPES, RUBBER RING JOINTED UNLESS OTHERWISE SPECIFIED.
18. DRAINAGE PITS SHALL BE CAST MONOLITHICALLY.
19. BACKFILLING OF TRENCHES WHERE DRAINAGE AND SEWERAGE ARE IN CLOSE PROXIMITY ARE TO BE BACKFILLED AS PER WYNDHAM CITY COUNCIL STANDARD DRAWING SD6-10.
20. ALL SERVICING TRENCHES UNDER ROADS, FOOTPATHS, DRIVEWAYS, PARKING BAYS ETC. ARE TO BE BACKFILLED WITH CLASS 2 F.C.R.
21. ALL HOUSE DRAIN CONNECTIONS ARE TO BE LOCATED NO CLOSER THAN 6.00m FROM THE SIDE BOUNDARY U.N.O.
22. INVERT OF PROPERTY INLETS TO BE 500mm MINIMUM BELOW FINISHED SURFACE UNLESS NOTED OTHERWISE.
23. VEHICLE CROSSINGS TO BE CONSTRUCTED IN ACCORDANCE WITH STANDARD DRAWINGS EDM 501 TO 503. DRIVEWAYS TO BE LOCATED MIN 0.75m FROM BUILDING LINE UNLESS SPECIFIED OTHERWISE AND CLEAR OF DRAINAGE PITS, SEWER MAINTENANCE HOLES AND EXISTING TREES. DOUBLE DRIVEWAY WIDTH TO BE 7.0m AT FRONT OF PATH/BUILDING LINE.
24. ADDITIONAL AND OVER-EXCAVATION SHALL BE BACKFILLED IN ACCORDANCE WITH THE PROVISIONS OF THE SPECIFICATION.
25. FOOTPATH CROSSFALL TO BE 1:50
26. ALL FOOTPATHS AND SHARED PEDESTRIAN/BICYCLE PATHS ARE TO BE CONSTRUCTED AS PER CITY OF WYNDHAM SPECIFICATIONS AND MPA STANDARD DRAWINGS EDM 401 TO 403.
27. ALL EXOTIC (NON NATIVE) TREES AND SHRUBS, INCLUDING DEAD TREES, NOT SHOWN ON THE DRAWINGS BUT LOCATED WITHIN THE WORKS ARE TO BE REMOVED AND DISPOSED OFFSITE.
28. INSTALL BLUE RAISED REFLECTIVE PAVEMENT MARKER (BRPM) ON ROAD CENTRELINE AND "GROUND BALL" MARKER POST TO INDICATE LOCATION OF FIREPLUG.
29. THE CONTRACTOR IS TO ENSURE THAT THEIR CONSTRUCTION PROCEDURES AND STANDARDS CONTROL THE VOLUME AND LOCATION FOR COLLECTION OF SEDIMENT RUNOFF ACCORDING TO CURRENT EPA - ENVIRONMENTAL GUIDELINES FOR MAJOR CONSTRUCTION SITES.
30. UPON COMPLETION OF CONSTRUCTION THE WHOLE SITE SHALL BE CLEANED UP, GRADED AND ALL RUBBISH REMOVED. THE SITE IS TO BE LEFT IN A CLEAN AND TIDY CONDITION TO THE SATISFACTION OF THE SUPERINTENDENT.
31. EXISTING PAVEMENT OR DRAINAGE WORKS DAMAGED DURING CONSTRUCTION OR THE MAINTENANCE PERIOD TO BE REINSTATED TO THE SATISFACTION OF THE COUNCIL ENGINEER.
32. THE LOWER SUB-BASE MATERIAL SHALL BE N.D.C.R. FOR PAVEMENT MAKE UPS AS PER THE STANDARD DRAWINGS OF WYNDHAM CITY COUNCIL.
33. TOTAL LENGTH OF ROADS CONSTRUCTED IS 766 m
TOTAL LENGTH OF DRAINS CONSTRUCTED IS 1104 m

GAS - STANDARD NOTES

1. GAS MAINS, FITTINGS AND MARKER TAPE ARE TO BE SUPPLIED BY THE GAS AUTHORITY.
2. EXCAVATION, SUPPLY AND PLACEMENT OF REQUIRED BACKFILL TO BE UNDERTAKEN BY OTHERS.
3. NOTIFICATION MUST BE GIVEN TO THE GAS AUTHORITY TWO WEEKS PRIOR TO THE COMMENCEMENT OF EXCAVATION WORKS.

REINFORCED CONCRETE PIPE

1. ALL STORMWATER DRAINAGE PIPES SHALL NOT BE SUBJECTED TO CONSTRUCTION TRAFFIC LOADING DURING CONSTRUCTION UNLESS THE PIPE STRENGTH CHARACTERISTICS HAVE BEEN COMPUTED AND APPROVED BY THE CONTRACTOR'S ENGINEER. COMPUTATIONS ARE TO ACCORD WITH AS 3725-2007, LOADS ON BURIED PIPES.
2. CONCRETE PIPES DAMAGED DUE TO CONSTRUCTION LOADS SHALL BE REPLACED & RELAID AT THE CONTRACTOR'S COST.

WARNING
SAFETY MEASURES REQUIRED
Please note there are risks attached to the construction of this project, and any ongoing maintenance of structures. Consider the safety of all. For potential risks, consequences and controls refer to Safety In Design Risk Register SID-P4.E6.2360E-06-500
ASSESS THE RISK - STAY SAFE

WARNING
BEWARE OF UNDERGROUND SERVICES
The locations of underground services are approximate only and their exact position should be proven on site. No guarantee is given that all existing services are shown. Locate all underground services before commencement of works
DIAL 1100 BEFORE YOU DIG
www.1100.com.au

AS CONSTRUCTED PLANS

The purpose of these as-constructed plans is to update the design drawings to show significant changes which occurred during construction. Note that the levels shown on these plans are design levels, and have not been verified by survey. All information shown on these plans should be verified on site. SMEC Australia Pty Ltd accept no responsibility for loss or damages resulting from the inappropriate usage of these plans.

Quality Management ISO 9001
OHS Management AS/NZS 4801
Environmental Management ISO 14001

Global-Mark.com.au® Global-Mark.com.au® Global-Mark.com.au®

PLAN OF SUB. NO.
PS900882T

PERMIT REF. NO.
WYP10365/17.01

AS CONSTRUCTED

0 25 50 100
Scale 1:2500
SCALE AS SHOWN AT 1

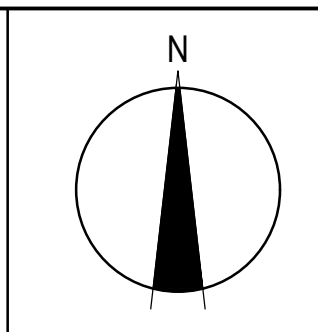

SMEC
Member of the Surlana Jurong Group
ABN 47 065 475 149
Collins Square, Tower 4, Level 20, 727 Collins St
Melbourne, VIC 3008
Ph 03 9514 1500

GROWLAND

Marigold - Stage 6
Wyndham City Council
Road and Drainage
Cover Plan & General Notes

MELBOURNE REF: 359 F9
PROJECT / DRAWING No: 2360E-006-101
SHEET No: 01 of 25
REVISION: 0

LEGEND - LAYOUT PLAN

ALL PROPOSED, FUTURE & EXISTING SERVICE LOCATIONS ARE SHOWN INDICATIVELY

- STORMWATER DRAIN, PIT & PROPERTY INLET
- MAIN DRAIN
- SWALE DRAIN
- SEWER & MAINTENANCE STRUCTURES
- HOUSE DRAIN
- ELECTRICITY (U. GROUND)
- ELECTRICITY (O. HEAD)
- GAS
- TELSTRA
- OPTIC FIBRE
- WATER
- RECYCLE WATER
- AG. DRAIN
- SERVICE CONDUITS
- TACTILE PAVERS
- EXISTING STORMWATER DRAIN
- EXISTING MAIN DRAIN
- EXISTING SWALE DRAIN
- EXISTING SEWER & MAINTENANCE STRUCTURES
- EXISTING HOUSE DRAIN
- EXISTING ELECTRICITY (UNDER GROUND)
- EXISTING ELECTRICITY OVERHEAD
- EXISTING GAS
- EXISTING TELSTRA
- EXISTING OPTIC FIBRE
- EXISTING WATER
- EXISTING RECYCLED WATER
- EXISTING AG. DRAIN
- EXISTING SERVICE CONDUITS
- EXISTING TACTILE PAVERS
- FUTURE STORMWATER DRAIN
- FUTURE MAIN DRAIN
- FUTURE SWALE DRAIN
- FUTURE SEWER & MAINTENANCE STRUCTURES
- FUTURE HOUSE DRAIN
- FUTURE ELECTRICITY (UNDER GROUND)
- FUTURE ELECTRICITY OVERHEAD
- FUTURE GAS
- FUTURE TELSTRA
- FUTURE OPTIC FIBRE
- FUTURE WATER
- FUTURE RECYCLED WATER
- FUTURE AG. DRAIN
- FUTURE SERVICE CONDUITS
- FUTURE TACTILE PAVERS
- ZERO LOT LINES
- 141.34 EXISTING SURFACE LEVEL
- FS140.35 FINISHED BOUNDARY LINE LEVEL
- FR157.40 FINISHED RIDGE LINE LEVEL
- CH270.00 CHAINAGE
- LC58.56 DRAINAGE LOT CONTROL
- IL48.37 HOUSE DRAIN INVERT LEVEL
- EXISTING STRUCTURAL FILL > 200mm DEEP
- CUT > 200mm DEEP
- DIRECTION OF FALL
- OVERLAND FLOW
- GRADED IN DIRECTION OF FALL TO LEVEL INDICATED
- EDGE STRIP, SUBSOIL DRAIN, "NO ROAD" SIGN & BARRIER
- EXISTING TREE TO BE RETAINED
- EXISTING TREE TO BE REMOVED
- PERMANENT SURVEY MARK
- TEMPORARY BENCH MARK
- PROPOSED DRIVEWAY & FOOTPATH
- PROPOSED INDUSTRIAL DRIVEWAY
- PROPOSED SHARED FOOTPATH
- PROPOSED ROAD PAVING
- EXISTING ROAD PAVING
- 3m DIAMETER TREE ZONE

WARNING
BEWARE OF UNDERGROUND SERVICES
 The locations of underground services are approximate only and their exact position should be proven on site.
 No guarantee is given that all existing services are shown.
 Locate all underground services before commencement of works
DIAL 1100 BEFORE YOU DIG
 www.1100.com.au

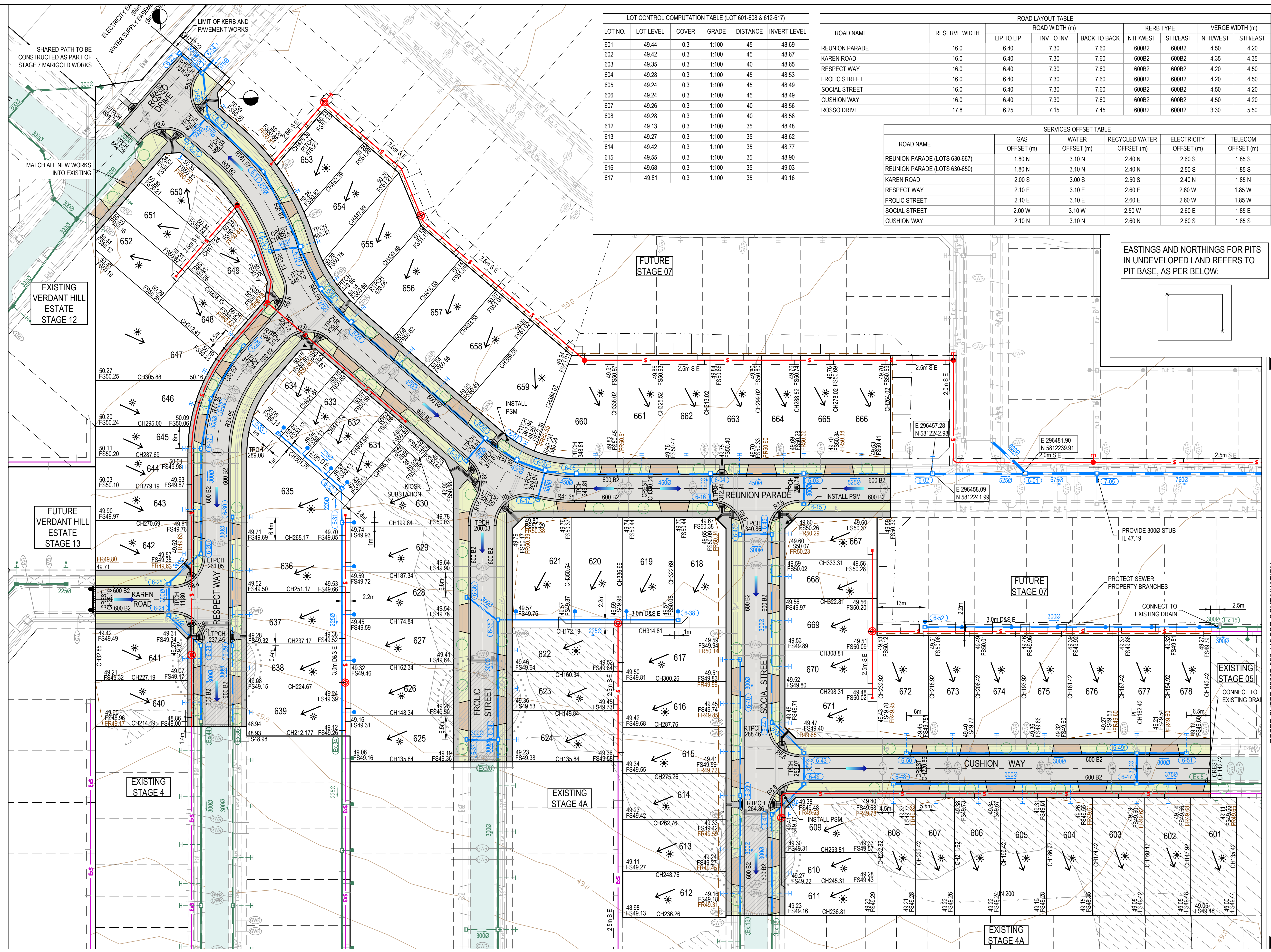

LOT CONTROL COMPUTATION TABLE (LOT 601-608 & 612-617)

LOT NO.	LOT LEVEL	COVER	GRADE	DISTANCE	INVERT LEVEL
601	49.44	0.3	1:100	45	48.69
602	49.42	0.3	1:100	45	48.67
603	49.35	0.3	1:100	40	48.65
604	49.28	0.3	1:100	45	48.53
605	49.24	0.3	1:100	45	48.49
606	49.24	0.3	1:100	45	48.49
607	49.26	0.3	1:100	40	48.56
608	49.28	0.3	1:100	40	48.58
612	49.13	0.3	1:100	35	48.48
613	49.27	0.3	1:100	35	48.62
614	49.42	0.3	1:100	35	48.77
615	49.55	0.3	1:100	35	48.90
616	49.68	0.3	1:100	35	49.03
617	49.81	0.3	1:100	35	49.16

ROAD LAYOUT TABLE

ROAD NAME	RESERVE WIDTH	ROAD WIDTH (m)		KERB TYPE		VERGE WIDTH (m)		
		LIP TO LIP	INV TO INV	BACK TO BACK	NTHWEST	STHEAST	NTHWEST	STHEAST
REUNION PARADE	16.0	6.40	7.30	7.60	600B2	600B2	4.50	4.20
KAREN ROAD	16.0	6.40	7.30	7.60	600B2	600B2	4.35	4.35
RESPECT WAY	16.0	6.40	7.30	7.60	600B2	600B2	4.20	4.50
FROLIC STREET	16.0	6.40	7.30	7.60	600B2	600B2	4.20	4.50
SOCIAL STREET	16.0	6.40	7.30	7.60	600B2	600B2	4.50	4.20
CUSHION WAY	16.0	6.40	7.30	7.60	600B2	600B2	4.50	4.20
ROSSO DRIVE	17.8	6.25	7.15	7.45	600B2	600B2	3.30	5.50

SERVICES OFFSET TABLE

ROAD NAME	GAS		WATER		RECYCLED WATER		ELECTRICITY		TELECOM	
	OFFSET (m)	OFFSET (m)	OFFSET (m)	OFFSET (m)	OFFSET (m)	OFFSET (m)	OFFSET (m)	OFFSET (m)	OFFSET (m)	
REUNION PARADE (LOTS 630-667)	1.80 N	3.10 N	2.40 N	2.40 N	2.50 S	2.60 S	1.85 S	1.85 S	1.85 S	
REUNION PARADE (LOTS 630-650)	1.80 N	3.10 N	2.40 N	2.40 N	2.50 S	2.60 S	1.85 S	1.85 S	1.85 S	
KAREN ROAD	2.00 S	3.00 S	2.50 S	2.40 N	2.50 S	2.60 S	1.85 S	1.85 S	1.85 S	
RESPECT WAY	2.10 E	3.10 E	2.60 E	2.60 W	2.60 W	2.60 W	1.85 W	1.85 W	1.85 W	
FROLIC STREET	2.10 E	3.10 E	2.60 E	2.60 W	2.60 W	2.60 W	1.85 W	1.85 W	1.85 W	
SOCIAL STREET	2.00 W	3.10 W	2.50 W	2.60 E	2.60 E	2.60 E	1.85 E	1.85 E	1.85 E	
CUSHION WAY	2.10 N	3.10 N	2.60 N	2.60 S	2.60 S	2.60 S	1.85 S	1.85 S	1.85 S	

EASTINGS AND NORTHINGS FOR PITS IN UNDEVELOPED LAND REFERS TO PIT BASE, AS PER BELOW:

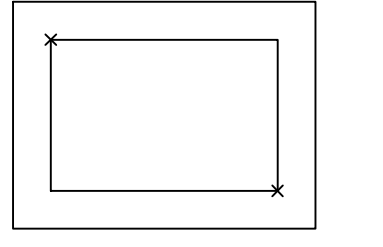

REFER SHEET 2360E-006-112 FOR CONTINUATION

AS CONSTRUCTED PLANS

The purpose of these as-constructed plans is to update the design drawings to show significant changes which occurred during construction. Note that the levels shown on these plans are design levels, and have not been verified by survey. All information shown on these plans should be verified on site. SMEC Australia Pty Ltd accept no responsibility for loss or damages resulting from the inappropriate usage of these plans.

Quality Management ISO 9001
 OHS Management AS/NZS 4801
 Environmental Management ISO 14001

PLAN OF SUB. NO.
 PS90082T
 PERMIT REF. NO.
 WYP10365/17.01

AS CONSTRUCTED

Scale 1:500
 SCALE AS SHOWN AT 1

SMEC
 Member of the Surlana Jurong Group
 ABN 47 065 475 149
 Collins Square, Tower 4, Level 20, 727 Collins St
 Melbourne, VIC 3008
 Ph 03 9514 1500

GROWLAND

Marigold - Stage 6
 Wyndham City Council
 Road and Drainage
 Layout Plan - 1

MELWAYS REF: 359 F9
 PROJECT / DRAWING No: 2360E-006-111
 SHEET No: 02 of 25
 REVISION: 5

LEGEND - LAYOUT PLAN

ALL PROPOSED, FUTURE & EXISTING SERVICE LOCATIONS ARE SHOWN INDICATIVELY

	STORMWATER DRAIN, PIT & PROPERTY INLET
	MAIN DRAIN
	SWALE DRAIN
	SEWER & MAINTENANCE STRUCTURES
	HOUSE DRAIN
	ELECTRICITY (U.GROUND)
	ELECTRICITY (O.HEAD)
	GAS
	TELSTRA
	OPTIC FIBRE
	WATER
	RECYCLE WATER
	AG. DRAIN
	SERVICE CONDUITS
	TACTILE PAVERS
	EXISTING STORMWATER DRAIN
	EXISTING MAIN DRAIN
	EXISTING SWALE DRAIN
	EXISTING SEWER & MAINTENANCE STRUCTURES
	EXISTING HOUSE DRAIN
	EXISTING ELECTRICITY (UNDER GROUND)
	EXISTING ELECTRICITY OVERHEAD
	EXISTING GAS
	EXISTING TELSTRA
	EXISTING OPTIC FIBRE
	EXISTING WATER
	EXISTING RECYCLED WATER
	EXISTING AG. DRAIN
	EXISTING SERVICE CONDUITS
	EXISTING TACTILE PAVERS
	FUTURE STORMWATER DRAIN
	FUTURE MAIN DRAIN
	FUTURE SWALE DRAIN
	FUTURE SEWER & MAINTENANCE STRUCTURES
	FUTURE HOUSE DRAIN
	FUTURE ELECTRICITY (UNDER GROUND)
	FUTURE ELECTRICITY OVERHEAD
	FUTURE GAS
	FUTURE TELSTRA
	FUTURE OPTIC FIBRE
	FUTURE WATER
	FUTURE RECYCLED WATER
	FUTURE AG. DRAIN
	FUTURE SERVICE CONDUITS
	FUTURE TACTILE PAVERS
	ZERO LOT LINES
	EXISTING SURFACE LEVEL
	FINISHED BOUNDARY LINE LEVEL
	FINISHED RIDGE LINE LEVEL
	CHAINAGE
	DRAINAGE LOT CONTROL
	HOUSE DRAIN INVERT LEVEL
	STRUCTURAL FILL > 200mm DEEP
	EXISTING STRUCTURAL FILL > 200mm DEEP
	CUT > 200mm DEEP
	DIRECTION OF FALL
	OVERLAND FLOW
	GRADED IN DIRECTION OF FALL TO LEVEL INDICATED
	EDGE STRIP, SUBSOIL DRAIN, "NO ROAD" SIGN & BARRIER
	EXISTING TREE TO BE RETAINED
	EXISTING TREE TO BE REMOVED
	PERMANENT SURVEY MARK
	TEMPORARY BENCH MARK
	PROPOSED DRIVEWAY & FOOTPATH
	PROPOSED INDUSTRIAL DRIVEWAY
	PROPOSED SHARED FOOTPATH
	PROPOSED ROAD PAVING
	EXISTING ROAD PAVING
	3m DIAMETER TREE ZONE



REFER SHEET 2350E-006-111 FOR CONTINUATION

WARNING
BEWARE OF UNDERGROUND SERVICES
 The locations of underground services are approximate only and their exact position should be proven on site.
 No guarantee is given that all existing services are shown.
 Locate all underground services before commencement of works
DIAL 1100 BEFORE YOU DIG
www.1100.com.au

AS CONSTRUCTED PLANS

The purpose of these as-constructed plans is to update the design drawings to show significant changes which occurred during construction. Note that the levels shown on these plans are design levels, and have not been verified by survey. All information shown on these plans should be verified on site. SMEC Australia Pty Ltd accept no responsibility for loss or damages resulting from the inappropriate usage of these plans.



AS CONSTRUCTED

PLAN OF SUB. NO.
 PS90082T
 PERMIT REF. NO.
 WYP10365/17.01

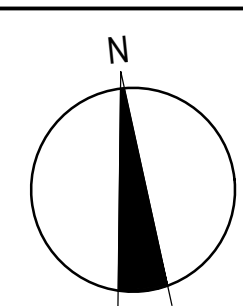
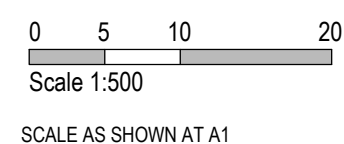

SMEC
 Member of the Surlana Jurong Group
 ABN 47 065 475 149
 Collins Square, Tower 4, Level 20, 727 Collins St
 Melbourne, VIC 3008
 Ph 03 9514 1500

GROWLAND

Marigold - Stage 6
 Wyndham City Council
 Road and Drainage
 Layout Plan - 2

MELWAYS REF 359 F9	PROJECT / DRAWING No. 2360E-006-112	SHEET No. 03 of 25	REVISION 4
-----------------------	--	-----------------------	---------------

LEGEND - EARTHWORKS PLAN	
141.34	EXISTING SURFACE LEVEL
FS140.35	FINISHED BUILDING LINE LEVEL
FR157.40	FINISHED RIDGE LINE LEVEL
	STRUCTURAL FILL > 200mm DEEP
	EXISTING STRUCTURAL FILL > 200mm DEEP
	CUT > 200mm DEEP
	DIRECTION OF FALL
	OVERLAND FLOW
*	GRADED IN DIRECTION OF FALL TO LEVEL INDICATED

NOTE:

- EARTHWORKS TO FINISH 200mm BELOW FS AND FR LEVELS SHOWN.
- LIMITED EARTHWORKS TO BE UNDERTAKEN WITHIN ROAD RESERVE OTHER THAN TO ENSURE IT REMAINS FREE DRAINING.



WARNING
BEWARE OF UNDERGROUND SERVICES
 The locations of underground services are approximate only and their exact position should be proven on site.
 No guarantee is given that all existing services are shown. Locate all underground services before commencement of works
DIAL 1100 BEFORE YOU DIG
 www.1100.com.au

AS CONSTRUCTED PLANS

The purpose of these as-constructed plans is to update the design drawings to show significant changes which occurred during construction. Note that the levels shown on these plans are design levels, and have not been verified by survey. All information shown on these plans should be verified on site. SMEC Australia Pty Ltd accept no responsibility for loss or damages resulting from the inappropriate usage of these plans.

Quality Management ISO 9001
 OHS Management AS/NZS 4801
 Environmental Management ISO 14001
 PLAN OF SUB. NO. PS900882T
 PERMIT REF. NO. WYP10365/17.01
AS CONSTRUCTED

Scale 1:500
 SCALE AS SHOWN AT A1

SMEC
 Member of the Surlana Jurong Group
 ABN 47 065 475 149
 Collins Square, Tower 4, Level 20, 727 Collins St
 Melbourne, VIC 3008
 Ph 03 9514 1500

GROWLAND

Marigold - Stage 6
 Wyndham City Council
 Road and Drainage
 Earthworks Setout Plan
 MELWAYS REF: 359 F9
 PROJECT / DRAWING No: 2360E-006-131
 SHEET No: 04 of 25
 REVISION: 0