

# Marigold Estate Stage 10 Landscape Plans

Wyndham City Council



**WARNING**  
**BEWARE OF UNDERGROUND SERVICES**  
 Note that the location shown of existing underground services is indicative only and may not be accurate at the time of landscape works. No guarantee is given that all existing services are shown. Determination of the exact position and extent of underground services is the responsibility of the Contractor and is to be confirmed on site prior to commencement of work.

**GENERAL NOTES**  
 1. Before commencement of works it is the responsibility of the Landscape Contractor to contact dial before you dig (ph. 1100 or web 1100.com.au) for information on services in the area shown on the plan.  
 2. The Contractor shall verify the location and depth of all services prior to commencing on site.  
 3. The Contractor shall be liable for any damage to services during landscape works.  
 4. The Contractor shall verify the location of any existing trees shown to be retained and protect them during works.  
 5. All trees shall be planted in locations shown on the plan.  
 6. Any change to plant species must have the approval of the Landscape Architect.  
 7. Trees shall be planted no less than the following distances from landscape elements:  
 Footpaths: 1.2m  
 Stormwater & sewerage pits: 2.0m  
 Service crossings: 1.5m  
 Street lights: 2.5m (Powercor standard offset)  
 8. Construction certification for all structural elements is to be provided prior to practical completion being granted.

**DRAWING SCHEDULE**

dwg #	dwg title	Revision
L000	Cover Sheet	D
L100	Landscape Plans 01	D
L101	Landscape Plans 02	D
L102	Landscape Plans 03	D
L103	Landscape Plans 04	D
L200	Landscape Details	D

LOCATION PLAN N.T.S.

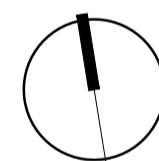
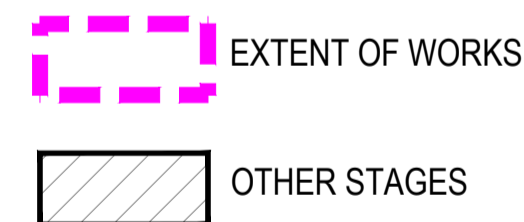

Revision	Description	Date	Drawn	Checked
D	ISSUE FOR COUNCIL APPROVAL	04.02.22	CX	DB
C	ISSUE FOR COUNCIL APPROVAL	20.08.21	MK	DB
B	ISSUE FOR COUNCIL APPROVAL	31.05.21	MK	DB
A	ISSUE FOR COORDINATION	25.03.21	MK	DB

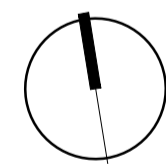

Scale (metres) As Shown @ A1

**SMEC**  
 Member of the Surbana Jurong Group  
 SMEC Australia Pty Ltd  
 Tower 4, Level 20, 727 Collins Street  
 Melbourne, VIC 3008, Australia  
 (PO Box 2007, Docklands,  
 VIC 3002, Australia)  
 T +61 3 9514 1500 F +61 3 9514 1502  
 E melbourne@smec.com  
 www.smec.com

**Planning and Environment Act 1987**  
**Wyndham Planning Scheme**  
**Landscape Plan No. LS3457/20**  
**WYP10365/17 WYS5723/21**  
**Plan 1 of 6**  
**Date 08/03/2022**

**Growland**  
**Marigold Estate**  
**Stage 10**

Cover Sheet

Designed	M.K.	Drawn	M.K.
Checked	D.B.	Approved	D.B.
Status	For Approval		
Date	Feb-22	Scale	As Shown
Job No.	30042360L.10	Sheet No.	1 of 6
Drawing No.	L000	Revision	D



**Planning and Environment Act 1987**  
**Wyndham Planning Scheme**  
**Landscape Plan No. LS3457/20**  
**WYP10365/17 WYS5723/21**  
**Plan 2 of 6**  
**Date 08/03/2022**

- LEGEND**
- EXTENT OF WORKS BOUNDARY
  - PROPOSED TREE (EVERGREEN)  
REFER PLANT SCHEDULE, DETAILS & SPECIFICATION
  - PROPOSED TREE (DECIDUOUS)  
REFER PLANT SCHEDULE, DETAILS & SPECIFICATION
  - PROPOSED TREE - LOCATION DOES NOT COMPLY WITH SERVICE OFFSET REQUIREMENTS. LOCATION TO BE CONFIRMED ON SITE WITH SUPERINTENDENT AND COUNCIL REPRESENTATIVE AT TIME OF CONTRACT.
  - PROPOSED GRASSING  
REFER DETAILS & SPECIFICATION
  - MULCHED GARDEN BED  
REFER DETAILS & SPECIFICATION

- SERVICES LEGEND**  
 REFER TO CIVIL DRAWINGS FOR UNDERGROUND SERVICES
- WATER SERVICE CONDUIT
  - GAS SERVICE CONDUIT
  - SEWERAGE SERVICE CONDUIT
  - DRAINAGE SERVICES
  - ELECTRICITY SERVICE CONDUIT
  - TELSTRA SERVICE CONDUIT
  - HOUSE DRAIN
  - SERVICE CONDUITS
  - STREETLIGHTS

**WARNING**  
**BEWARE OF UNDERGROUND SERVICES**  
 Note that the location shown of existing underground services is indicative only and may not be accurate at the time of landscape works. No guarantee is given that all existing services are shown. Determination of the exact position and extent of underground services is the responsibility of the Contractor and is to be confirmed on site prior to commencement of work.

**GENERAL NOTES**

1. Before commencement of works it is the responsibility of the Landscape Contractor to contact dial before you dig (ph. 1100 or web 1100.com.au) for information on services in the area shown on the plan.
2. The Contractor shall verify the location and depth of all services prior to commencing on site.
3. The Contractor shall be liable for any damage to services during landscape works.
4. The Contractor shall verify the location of any existing trees shown to be retained and protect them during works.
5. All trees shall be planted in locations shown on the plan.
6. Any change to plant species must have the approval of the Landscape Architect.
7. Trees shall be planted no less than the following distances from landscape elements:  
 Footpaths: 1.2m  
 Stormwater & sewerage pits: 2.0m  
 Driveways and crossings: 2.5m  
 Service crossings: 1.5m  
 Intersections: 10.0m  
 Kerb & channel: 2.0m  
 Street lights: 2.5m (Powercor standard offset)
8. Construction certification for all structural elements is to be provided prior to practical completion being granted.

Revision	Description	Date	Drawn	Checked
D	ISSUE FOR COUNCIL APPROVAL	04.02.22	CX	DB
C	ISSUE FOR COUNCIL APPROVAL	20.08.21	MK	DB
B	ISSUE FOR COUNCIL APPROVAL	31.05.21	MK	DB
A	ISSUE FOR COORDINATION	25.03.21	MK	DB

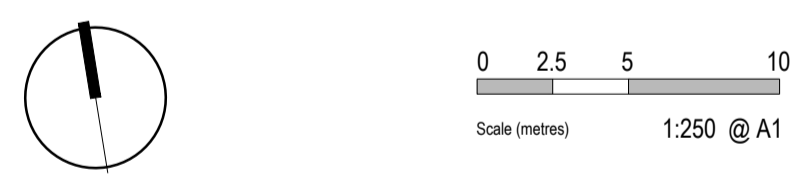

**SMEC**  
 Member of the **Surbana Jurong Group**

SMEC Australia Pty Ltd  
 Tower 4, Level 20, 727 Collins Street  
 Melbourne, VIC 3008, Australia  
 (P.O. Box 2807, Docklands,  
 VIC 3002, Australia)  
 T +61 3 9514 1500 F +61 3 9514 1502  
 E melbourne@smec.com  
 www.smec.com

**Growland**  
**Marigold Estate**  
 Stage 10

Landscape Plans 01

Designed: M.K. Drawn: M.K.  
 Checked: D.B. Approved: D.B.

Status: For Approval

Date: Feb-22 Scale: 1:250 Sheet No: 2 of 6  
 Job No: 30042360L.10 Drawing No: L100 Revision: D

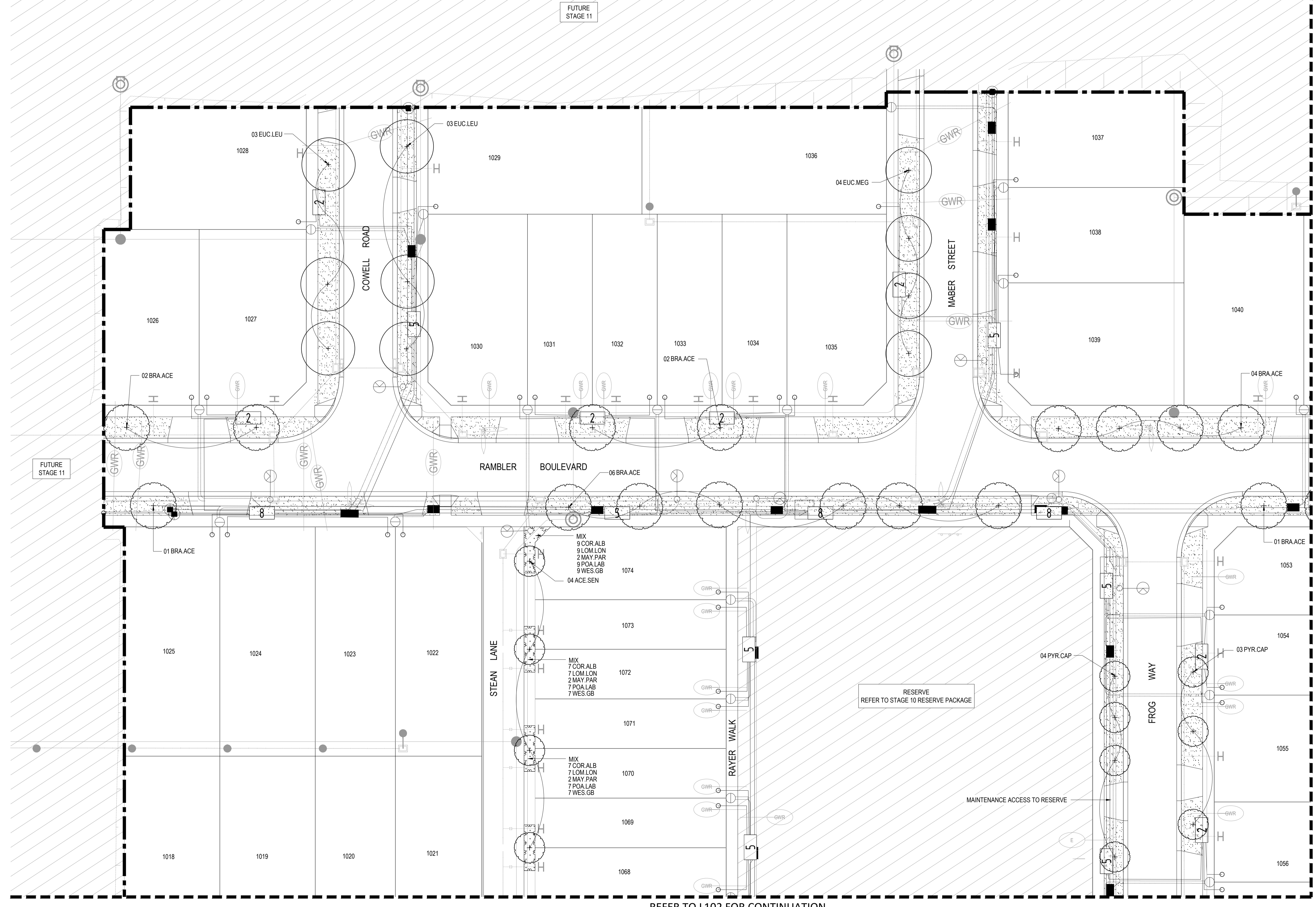

REFER TO L101 FOR CONTINUATION

REFER TO L102 FOR CONTINUATION



- LEGEND**
- EXTENT OF WORKS BOUNDARY
  - PROPOSED TREE (EVERGREEN)  
REFER PLANT SCHEDULE, DETAILS & SPECIFICATION
  - PROPOSED TREE (DECIDUOUS)  
REFER PLANT SCHEDULE, DETAILS & SPECIFICATION
  - PROPOSED TREE - LOCATION DOES NOT COMPLY WITH SERVICE OFFSET REQUIREMENTS. LOCATION TO BE CONFIRMED ON SITE WITH SUPERINTENDENT AND COUNCIL REPRESENTATIVE AT TIME OF CONTRACT.
  - PROPOSED GRASSING  
REFER DETAILS & SPECIFICATION
  - MULCHED GARDEN BED  
REFER DETAILS & SPECIFICATION

- SERVICES LEGEND**  
REFER TO CIVIL DRAWINGS FOR UNDERGROUND SERVICES
- WATER SERVICE CONDUIT
  - GAS SERVICE CONDUIT
  - SEWERAGE SERVICE CONDUIT
  - DRAINAGE SERVICES
  - ELECTRICITY SERVICE CONDUIT
  - TELSTRA SERVICE CONDUIT
  - HOUSE DRAIN
  - SERVICE CONDUITS
  - STREETLIGHTS

**WARNING**  
**BEWARE OF UNDERGROUND SERVICES**

Note that the location shown of existing underground services is indicative only and may not be accurate at the time of landscape works. No guarantee is given that all existing services are shown. Determination of the exact position and extent of underground services is the responsibility of the Contractor and is to be confirmed on site prior to commencement of work.

- GENERAL NOTES**
1. Before commencement of works it is the responsibility of the Landscape Contractor to contact dial before you dig (ph. 1100 or web 1100.com.au) for information on services in the area shown on the plan.
  2. The Contractor shall verify the location and depth of all services prior to commencing on site.
  3. The Contractor shall be liable for any damage to services during landscape works.
  4. The Contractor shall verify the location of any existing trees shown to be retained and protect them during works.
  5. All trees shall be planted in locations shown on the plan.
  6. Any change to plant species must have the approval of the Landscape Architect.
  7. Trees shall be planted no less than the following distances from landscape elements:  
Footpaths: 1.2m  
Stormwater & sewerage pits: 2.0m  
Service crossings: 1.5m  
Kerb & channel: 2.0m  
Street lights: 2.5m (Powercor standard offset)
  8. Construction certification for all structural elements is to be provided prior to practical completion being granted.

Revision	Description	Date	Drawn	Checked
D	ISSUE FOR COUNCIL APPROVAL	04.02.22	CX	DB
C	ISSUE FOR COUNCIL APPROVAL	20.08.21	MK	DB
B	ISSUE FOR COUNCIL APPROVAL	31.05.21	MK	DB
A	ISSUE FOR COORDINATION	25.03.21	MK	DB



**SMEC**  
Member of the Surlana Jurgong Group

SMEC Australia Pty Ltd  
Tower 4, Level 20, 727 Collins Street  
Melbourne, VIC 3008, Australia  
PO Box 2827, Docklands,  
VIC 3002, Australia  
T +61 3 9514 1500 F +61 3 9514 1502  
E melbourne@smec.com  
www.smec.com

**Growland**  
**Marigold Estate**  
Stage 10

Landscape Plans 02

Designed M.K. Drawn M.K.  
Checked D.B. Approved D.B.

Status For Approval

Date Feb-22 Scale 1:250 Sheet No. 3 of 6

Job No. 30042360L.10 Drawing No. L101 Revision D

REFER TO L100 FOR CONTINUATION

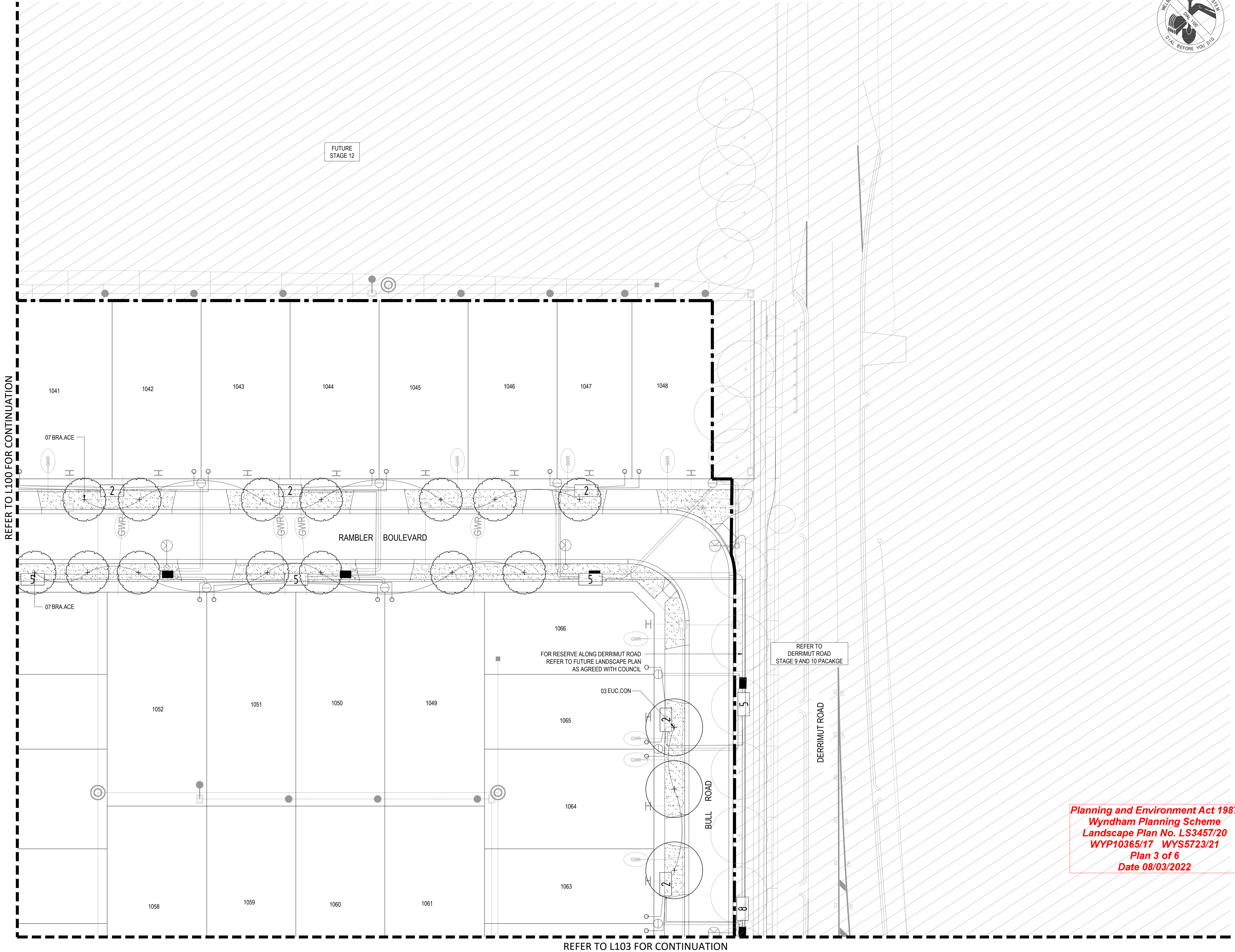

REFER TO L103 FOR CONTINUATION

**Planning and Environment Act 1987**  
**Wyndham Planning Scheme**  
**Landscape Plan No. LS3457/20**  
**WYP10365/17 WYS5723/21**  
**Plan 3 of 6**  
**Date 08/03/2022**

REFER TO L100 FOR CONTINUATION

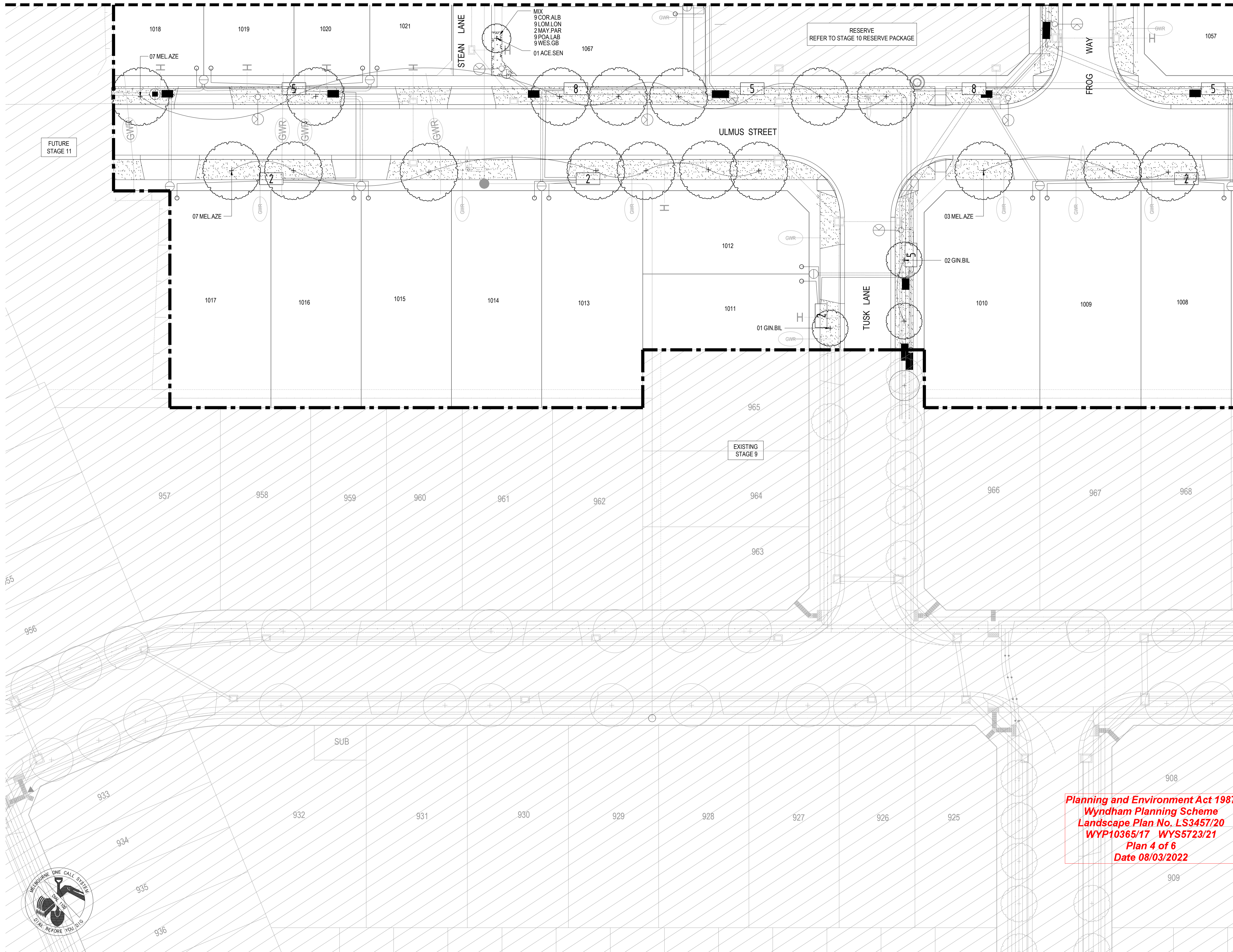

- LEGEND**
- EXTENT OF WORKS BOUNDARY
  - PROPOSED TREE (EVERGREEN)  
REFER PLANT SCHEDULE, DETAILS & SPECIFICATION
  - PROPOSED TREE (DECIDUOUS)  
REFER PLANT SCHEDULE, DETAILS & SPECIFICATION
  - PROPOSED TREE - LOCATION DOES NOT COMPLY WITH SERVICE OFFSET REQUIREMENTS. LOCATION TO BE CONFIRMED ON SITE WITH SUPERINTENDENT AND COUNCIL REPRESENTATIVE AT TIME OF CONTRACT.
  - PROPOSED GRASSING  
REFER DETAILS & SPECIFICATION
  - MULCHED GARDEN BED  
REFER DETAILS & SPECIFICATION

- SERVICES LEGEND**  
REFER TO CIVIL DRAWINGS FOR UNDERGROUND SERVICES
- WATER SERVICE CONDUIT
  - GAS SERVICE CONDUIT
  - SEWERAGE SERVICE CONDUIT
  - DRAINAGE SERVICES
  - ELECTRICITY SERVICE CONDUIT
  - TELSTRA SERVICE CONDUIT
  - HOUSE DRAIN
  - SERVICE CONDUITS
  - STREETLIGHTS

**WARNING**  
**BEWARE OF UNDERGROUND SERVICES**

Note that the location shown of existing underground services is indicative only and may not be accurate at the time of landscape works. No guarantee is given that all existing services are shown. Determination of the exact position and extent of underground services is the responsibility of the Contractor and is to be confirmed on site prior to commencement of work.

- GENERAL NOTES**
1. Before commencement of works it is the responsibility of the Landscape Contractor to contact dial before you dig (ph. 1100 or web 1100.com.au) for information on services in the area shown on the plan.
  2. The Contractor shall verify the location and depth of all services prior to commencing on site.
  3. The Contractor shall be liable for any damage to services during landscape works.
  4. The Contractor shall verify the location of any existing trees shown to be retained and protect them during works.
  5. All trees shall be planted in locations shown on the plan.
  6. Any change to plant species must have the approval of the Landscape Architect.
  7. Trees shall be planted no less than the following distances from landscape elements:  
Footpaths: 1.2m  
Stormwater & sewerage pits: 2.0m  
Service crossings: 1.5m  
Street lights: 2.5m (Powercor standard offset)
  8. Construction certification for all structural elements is to be provided prior to practical completion being granted.

Revision	Description	Date	Drawn	Checked
D	ISSUE FOR COUNCIL APPROVAL	04.02.22	CX	DB
C	ISSUE FOR COUNCIL APPROVAL	20.08.21	MK	DB
B	ISSUE FOR COUNCIL APPROVAL	31.05.21	MK	DB
A	ISSUE FOR COORDINATION	25.03.21	MK	DB



**SMEC**  
Member of the Surlana Jurong Group

SMEC Australia Pty Ltd  
Tower 4, Level 20, 727 Collins Street  
Melbourne, VIC 3008, Australia  
PO Box 28207, Docklands,  
VIC 3002, Australia  
T +61 3 9514 1500 F +61 3 9514 1502  
E melbourne@smec.com  
www.smec.com

**Planning and Environment Act 1987**  
**Wyndham Planning Scheme**  
**Landscape Plan No. LS3457/20**  
**WYP10365/17 WYS5723/21**  
**Plan 4 of 6**  
**Date 08/03/2022**

**Growland**  
**Marigold Estate**  
**Stage 10**

**Landscape Plans 03**

Designed: M.K. Drawn: M.K.  
Checked: D.B. Approved: D.B.

Status: For Approval

Date: Feb-22 Scale: 1:250 Sheet No: 4 of 6  
Job No: 30042360L.10 Drawing No: L102 Revision: D



REFER TO L101 FOR CONTINUATION

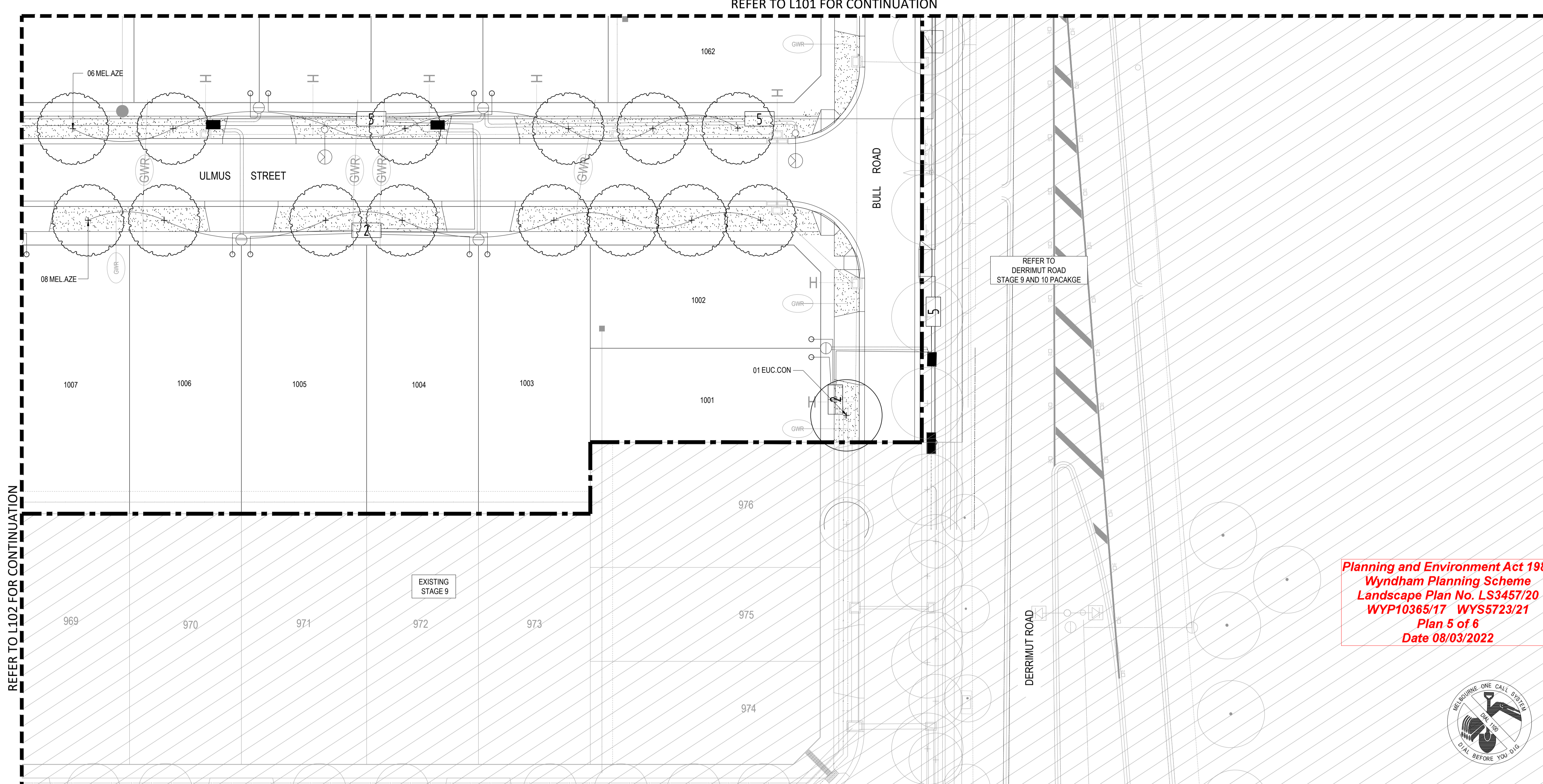

- LEGEND**
- EXTENT OF WORKS BOUNDARY
  - PROPOSED TREE (EVERGREEN)  
REFER PLANT SCHEDULE, DETAILS & SPECIFICATION
  - PROPOSED TREE (DECIDUOUS)  
REFER PLANT SCHEDULE, DETAILS & SPECIFICATION
  - PROPOSED TREE - LOCATION DOES NOT COMPLY WITH SERVICE OFFSET REQUIREMENTS. LOCATION TO BE CONFIRMED ON SITE WITH SUPERINTENDENT AND COUNCIL REPRESENTATIVE AT TIME OF CONTRACT.
  - PROPOSED GRASSING  
REFER DETAILS & SPECIFICATION
  - MULCHED GARDEN BED  
REFER DETAILS & SPECIFICATION

- SERVICES LEGEND**  
REFER TO CIVIL DRAWINGS FOR UNDERGROUND SERVICES
- WATER SERVICE CONDUIT
  - GAS SERVICE CONDUIT
  - SEWERAGE SERVICE CONDUIT
  - DRAINAGE SERVICES
  - ELECTRICITY SERVICE CONDUIT
  - TELSTRA SERVICE CONDUIT
  - HOUSE DRAIN
  - SERVICE CONDUITS
  - STREETLIGHTS

**WARNING**  
**BEWARE OF UNDERGROUND SERVICES**

Note that the location shown of existing underground services is indicative only and may not be accurate at the time of landscape works. No guarantee is given that all existing services are shown. Determination of the exact position and extent of underground services is the responsibility of the Contractor and is to be confirmed on site prior to commencement of work.

- GENERAL NOTES**
1. Before commencement of works it is the responsibility of the Landscape Contractor to contact dial before you dig (ph. 1100 or web 1100.com.au) for information on services in the area shown on the plan.
  2. The Contractor shall verify the location and depth of all services prior to commencing on site.
  3. The Contractor shall be liable for any damage to services during landscape works.
  4. The Contractor shall verify the location of any existing trees shown to be retained and protect them during works.
  5. All trees shall be planted in locations shown on the plan.
  6. Any change to plant species must have the approval of the Landscape Architect.
  7. Trees shall be planted no less than the following distances from landscape elements:  
Footpaths: 1.2m  
Stormwater & sewerage pits: 2.0m  
Intersections: 10.0m  
Services crossings: 1.5m  
Kerb & channel: 2.0m  
Street lights: 2.5m (Powercor standard offset)
  8. Construction certification for all structural elements is to be provided prior to practical completion being granted.

Planning and Environment Act 1987  
Wyndham Planning Scheme  
Landscape Plan No. LS3457/20  
WYP10365/17 WYS5723/21  
Plan 5 of 6  
Date 08/03/2022



**STAGE 10 STREETScape PLANT SCHEDULE**

Code	Plant Species	Common Name	HxW (m)	Density	Installation size	Quantity
Advanced Trees <span style="float: right;">ALL TREES TO CONFORM TO AS2303:2018</span>						
ACE.SEN	<i>Acer platanoides 'Crimson Sentry'</i>	Fastigiata Japanese Maple	7 x 4m	As shown	45lt/30mm CAL/2.0m ht	5
BRA.ACE	<i>Brachychiton acerifolius</i>	Illawarra Flame Tree	12 x 6m	As shown	45lt/30mm CAL/2.0m ht	30
EUC.CON	<i>Eucalyptus leucoxylon ssp. Connata</i>	Yellow Gum	10-12 x 5-10m	As shown	45lt/30mm CAL/2.0m ht	4
EUC.LEU	<i>Eucalyptus leucoxylon 'Rosea'</i>	Red Flowering Yellow Gum	12-15 x 7m	As shown	45lt/30mm CAL/2.0m ht	6
EUC.MEG	<i>Eucalyptus leucoxylon megalocarpa</i>	Large Fruited Yellow Gum	8 x 6m	As shown	45lt/30mm CAL/2.0m ht	4
GIN.BIL	<i>Ginkgo biloba (Male version)</i>	Maidenhair Tree	12 x 5m	As shown	45lt/30mm CAL/2.0m ht	3
MEL.AZE	<i>Melia azedarach 'Elite'</i>	White Cedar	10 x 8m	As shown	45lt/30mm CAL/2.0m ht	31
PYR.CAP	<i>Pyrus calleryana 'Capital'</i>	Capital' Ornamental Pear	11 x 4m	As Shown	45lt/30mm CAL/2.0m ht	7
<b>TREES TOTAL</b>						<b>90</b>

Code	Plant Species	Common Name	HxW (m)	Density	Installation size	Quantity
Shrubs, Grasses and Groundcovers						
COR.ALB	<i>Correa alba</i>	White Correa	1.5 x 1.5m	4/ m <sup>2</sup>	tubestock	32
LOM.LON	<i>Lomandra longifolia</i>	Spiny-head Mat Rush	1.0m x 1.2m	4/ m <sup>2</sup>	tubestock	32
MAY.PAR	<i>Myoporum parvifolium</i>	Creeping Boobialla	0.2 x 1.5-2.0m	1/ m <sup>2</sup>	tubestock	8
POA.LAB	<i>Poa labillardieri</i>	Common Tussock	0.8m x 0.6m	4/ m <sup>2</sup>	tubestock	32
WES.GB	<i>Westringia fruticosa 'Grey Box'</i>	Native Rosemary	0.5 x 0.5m	4/ m <sup>2</sup>	tubestock	32
<b>SHRUBS, GRASSES AND GROUNDCOVERS TOTAL</b>						<b>136</b>

Revision	Description	Date	Drawn	Checked
D	ISSUE FOR COUNCIL APPROVAL	04.02.22	CX	DB
C	ISSUE FOR COUNCIL APPROVAL	20.08.21	MK	DB
B	ISSUE FOR COUNCIL APPROVAL	31.05.21	MK	DB
A	ISSUE FOR COORDINATION	25.03.21	MK	DB



**SMEC**  
Member of the Surlana Jurong Group

SMEC Australia Pty Ltd  
Tower 4, Level 20, 727 Collins Street  
Melbourne, VIC 3008, Australia  
(P.O. Box 2007, Docklands,  
VIC 3002, Australia)  
T +61 3 9514 1500 F +61 3 9514 1502  
E melbourne@smec.com  
www.smec.com

**Growland**  
**Marigold Estate**  
Stage 10

Landscape Plans 04

Designed: M.K. Drawn: M.K.  
Checked: D.B. Approved: D.B.

Status: For Approval

Date: Feb-22 Scale: 1:250 Sheet No: 5 of 6  
Job No: 30042360L.10 Drawing No: L103 Revision: D



**WARNING**  
**BEWARE OF UNDERGROUND SERVICES**  
 Note that the location shown of existing underground services is indicative only and may not be accurate at the time of landscape works. No guarantee is given that all existing services are shown. Determination of the exact position and extent of underground services is the responsibility of the Contractor and is to be confirmed on site prior to commencement of work.

**GENERAL NOTES**  
 1. Before commencement of works it is the responsibility of the Landscape Contractor to contact dial before you dig (ph. 1100 or web 1100.com.au) for information on services in the area shown on the plan.  
 2. The Contractor shall verify the location and depth of all services prior to commencing on site.  
 3. The Contractor shall be liable for any damage to services during landscape works.  
 4. The Contractor shall verify the location of any existing trees shown to be retained and protect them during works.  
 5. All trees shall be planted in locations shown on the plan.  
 6. Any change to plant species must have the approval of the Landscape Architect.  
 7. Trees shall be planted no less than the following distances from landscape elements:  
 Footpaths: 1.2m Intersections: 10.0m  
 Stormwater & sewerage pits: 2.0m Driveways and crossings: 2.5m  
 Service crossings: 1.5m Kerb & channel: 2.0m  
 Street lights: 2.5m (Powercor standard offset)  
 8. Construction certification for all structural elements is to be provided prior to practical completion being granted.

Revision	Description	Date	Drawn	Checked
D	ISSUE FOR COUNCIL APPROVAL	04.02.22	CX	DB
C	ISSUE FOR COUNCIL APPROVAL	20.08.21	MK	DB
B	ISSUE FOR COUNCIL APPROVAL	31.05.21	MK	DB
A	ISSUE FOR COORDINATION	25.03.21	MK	DB



**SMEC**  
 Member of the **Surbana Jurong Group**  
 SMEC Australia Pty Ltd  
 Tower 4, Level 20, 727 Collins Street  
 Melbourne, VIC 3008, Australia  
 (P.O. Box 28207, Docklands,  
 VIC 3002, Australia)  
 T +61 3 9514 1500 F +61 3 9514 1502  
 E melbourne@smec.com  
 www.smec.com

**Growland**  
**Marigold Estate**  
**Stage 10**

**Landscape Details**

Designed M.K. Drawn M.K.  
 Checked D.B. Approved D.B.

Status For Approval

Date Feb-22 Scale As Shown Sheet No. 6 of 6  
 Job No. 30042360L.10 Drawing No. L200 Revision D

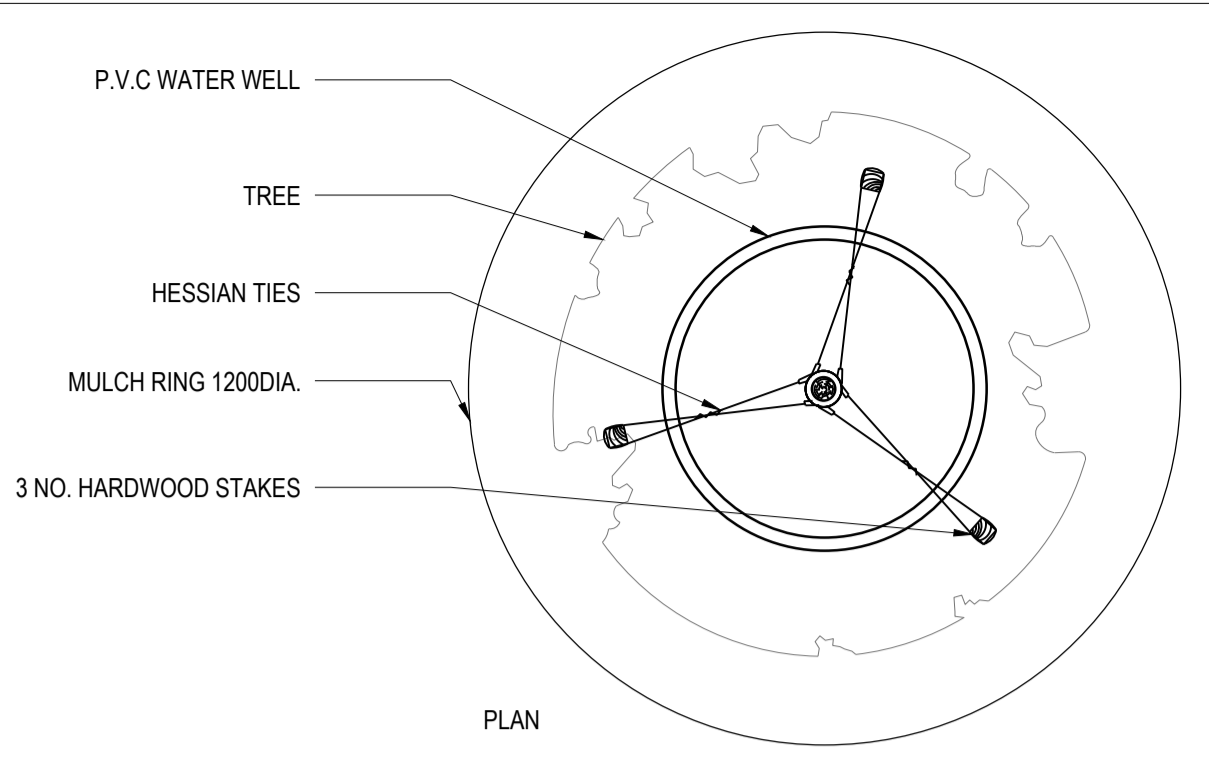

NOTE: IT IS THE RESPONSIBILITY OF THE CONTRACTOR TO CONFIRM THE LOCATION OF ALL UNDERGROUND SERVICES PRIOR TO COMMENCEMENT OF ANY EXCAVATION OR STAKING WORKS.

NOTE: TREE WATERING 1: 1ST INITIAL WATERING AT THE TIME OF PLANTING, POTABLE WATER IS TO BE MIXED WITH "GARRETT" JUICE OR ANOTHER WCC APPROVED ROOT PROMOTER PRODUCT AT APPROPRIATE RATES. ALL SUBSEQUENT WATERING OF TREES POST PLANTING - PROVIDE A MIN. 15LTS OF WATER OF APPROVED QUALITY MIXED WITH "SEASOIL" OR ANOTHER WCC APPROVED LIQUID SEA WEEED PRODUCT AT APPROPRIATE RATES. WATER IS TO BE DELIVERED INSIDE THE WATERWELL AT A RATE APPLICABLE SO AS NOT TO DISTURB MULCH.

NOTE: STRONG CENTRAL LEADING TRUNK TO BE EVIDENT AT TIME OF PLANTING

ALL TREES SUPPLIED MUST MEET THE CRITERIA OF AS2303-2015: TREE STOCK FOR LANDSCAPE USE & BE HEALTHY SPECIMENS FREE OF PESTS AND DISEASES. TREES TO BE WELL WATERED OF A MAXIMUM OF 24 HOURS PRIOR TO PLANTING

SET 3 OF 38X38X2400MM HARDWOOD STAKES VERTICALLY AND CLEAR OF ROOT BALL AND CANOPY AT 900MM SPACING, OFFSET A MIN. 200MM FROM UNDERGROUND SERVICES TO ENSURE NO DAMAGE IS CAUSED TO SERVICES. STAKES MUST BE POSITIONED SO AS TO PREVENT DAMAGE TO STRUCTURAL BRANCHES AND PREVENT RUBBING ON BRANCHES.

50MM WIDE HESSIAN TIES OF GOOD QUALITY WRAPPED AROUND THE TRUNK AND NAILED OR STAPLED TO THE STAKE. TREE TIE IS TO BE POSITIONED AS HIGH AS POSSIBLE, LOOPED AROUND THE TRUNK AND NOT THE BRANCHES, AND BE LOOSE, HOWEVER STILL BE TIGHT ENOUGH TO PREVENT EXCESSIVE MOVEMENT

POSITION TREE IN HOLE WITH THE TOP OF THE ROOTBALL AT THE SAME HEIGHT AS THE SURROUNDING GROUND AND BACKFILL WITH 50/50 BLEND OF SITE SOIL AND IMPORTED ORGANIC TOPSOIL. IMPORTED ORGANIC TOPSOIL MUST BE AS PER AS:4419 2003: SOILS FOR LANDSCAPE & GARDENS.

AT THE TIME OF PLANTING, IF THE ROOTS ARE MATTED, SLICE THE BOTTOM 50MM OFF AND APPLY THE SPADE TO THE BOTTOM IN EACH QUADRANT.

POSITION P.V.C. WATER WELL WITH THE TOP OF THE WATER WELL NO GREATER THAN 150MM ABOVE G.L. AND IN STRAIGHT POSITION PARALLEL TO THE NATURESTRIP

APPLY AND SPREAD WCC APPROVED RAW COARSE MULCH (AS PER AS4454-2012) TO A DEPTH OF 150MM AND 1200MM DIAMETER FROM TREE

APPLY 500GMS OF GYPSUM TO THE PLANTING SITE AT A RADIUS OF A MINIMUM 1200MM DIAMETER FROM CENTRE OF HOLE

APPLY WCC APPROVED RAW COARSE MULCH (AS PER AS4454-2012) TO 25MM DEPTH INSIDE THE WATER WELL. NO MULCH IS TO BE TOUCHING THE TREE.

APPLY 500gms OF GYPSUM TO INSIDE OF HOLE. LIGHTLY COMPACT SOIL AT THE BASE TO PREVENT SETTLING.

EXCAVATE A PLANTING HOLE WITH SLOPING SIDES 3 TIMES THE WIDTH OF THE ROOTBALL. BREAK UP SIDES AND BASE. IF DIGGING IN SOIL OF LOW PERMEABILITY, THE HOLE SHOULD BE WIDER AND DEEPER. IN THIS INSTANCE BACKFILL WILL BE REQUIRED AT BASE OF HOLE. AUGERS ARE NOT TO BE USED FOR EXCAVATION OF THE PLANTING HOLE. PLANTING HOLE IS TO BE WATERED PRIOR TO PLANTING. NO TREE IS TO BE PLANTED INTO NATURALLY WATERLOGGED SOIL. IF SOIL IS WATERLOGGED, PLANTING MUST BE RESCHEDULED TO ALLOW SUFFICIENT TIME FOR THE SOIL TO DRY OUT.

**1 TYPICAL ADVANCE TREE PLANTING DETAIL (3 STAKES)**  
 SCALE 1:20

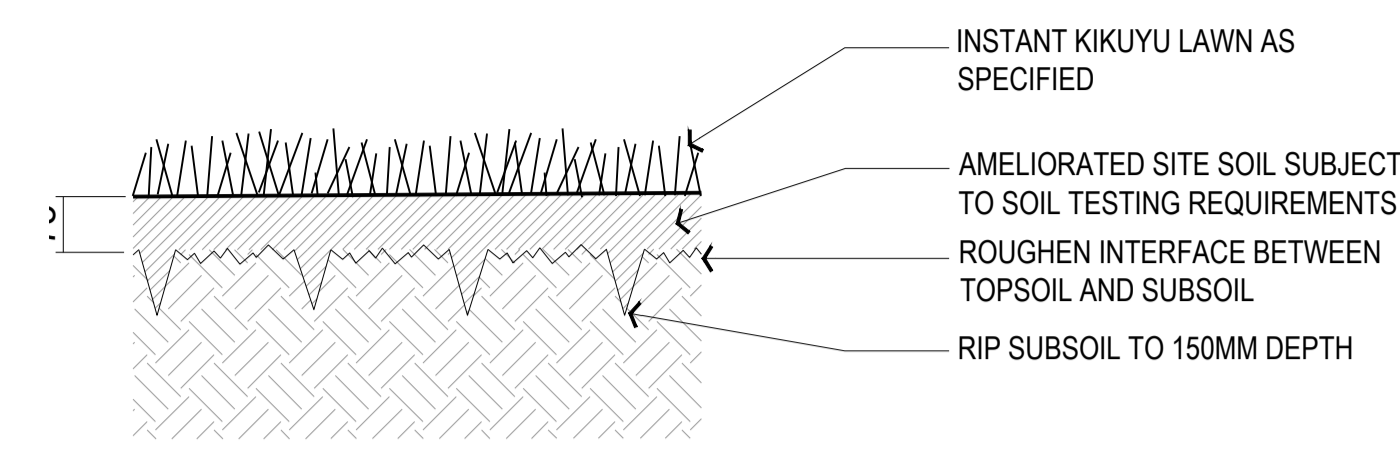

**2 GRASSED AREAS**  
 SCALE 1:10

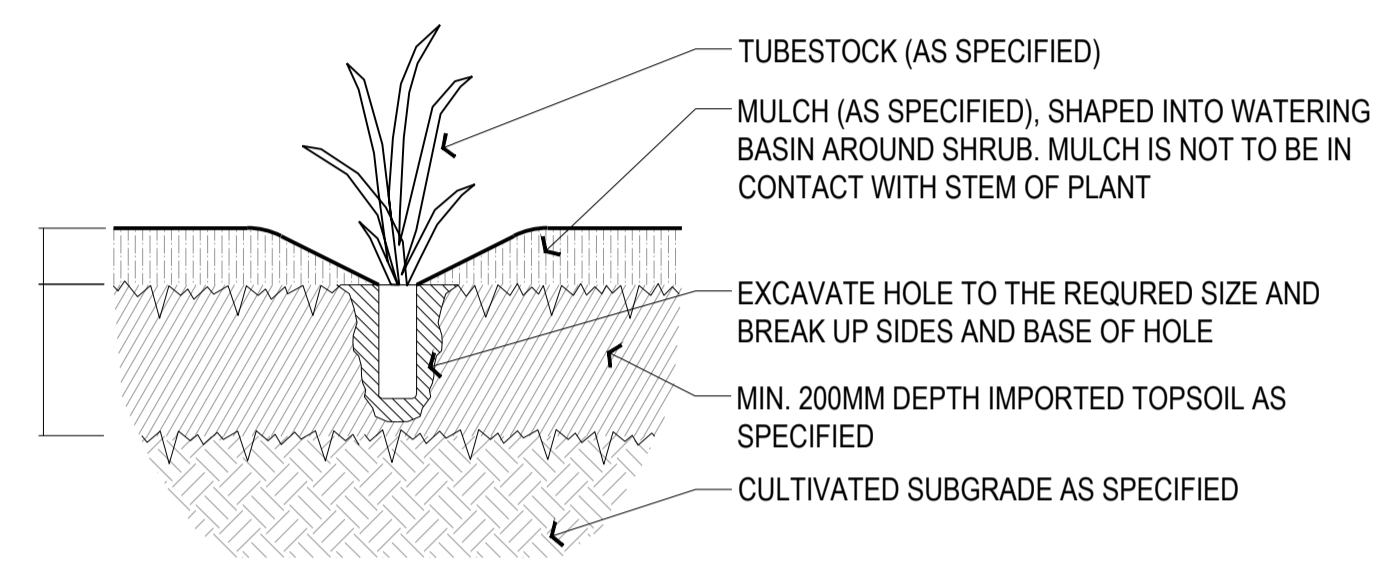

**3 TYPICAL TUBE STOCK PLANTING DETAIL**  
 SCALE 1:10

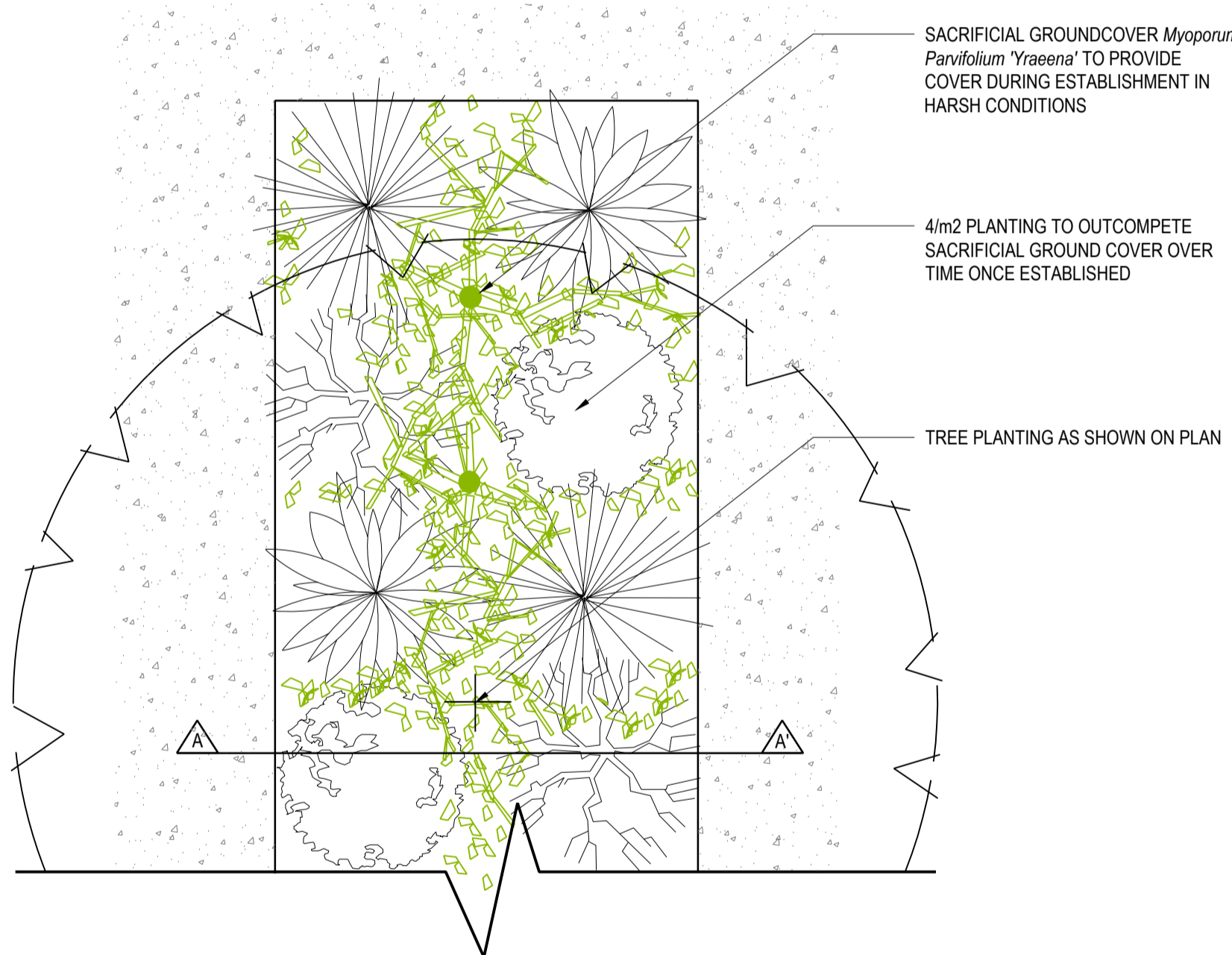

**4 TYPICAL LANEWAY PLANTING - PLAN**  
 SCALE 1:20

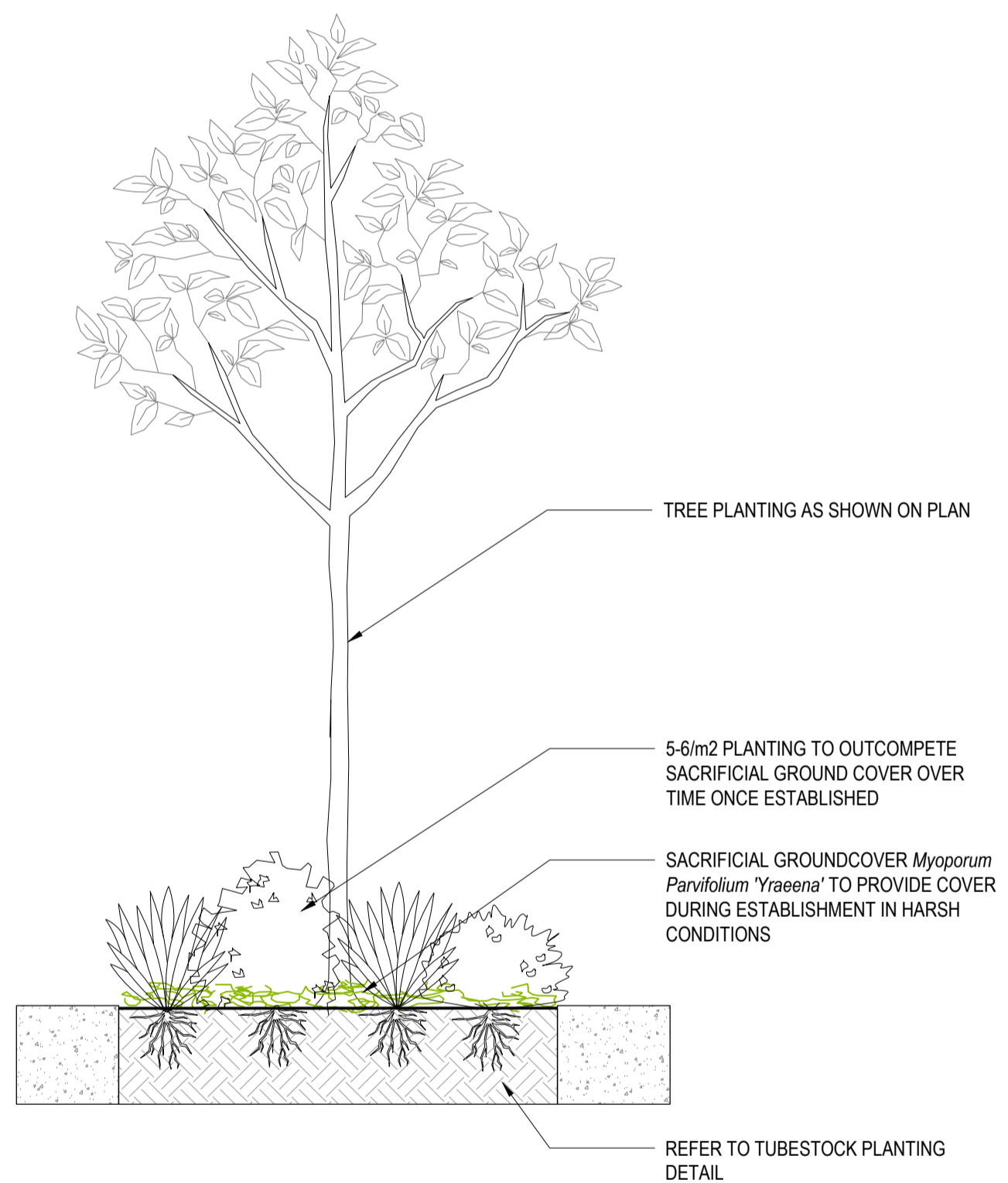

**5 TYPICAL LANEWAY PLANTING - SECTION AA'**  
 SCALE 1:20