

# Marigold Estate Stage 7 Streetscapes Landscape Plans

Wyndham City Council



**WARNING**  
**BEWARE OF UNDERGROUND SERVICES**  
Note that the location shown of existing underground services is indicative only and may not be accurate at the time of landscape works. No guarantee is given that all existing services are shown. Determination of the exact position and extent of underground services is the responsibility of the Contractor and is to be confirmed on site prior to commencement of work.

**GENERAL NOTES**  
1. Before commencement of works it is the responsibility of the Landscape Contractor to contact dial before you dig (ph. 1100 or web 1100.com.au) for information on services in the area shown on the plan.  
2. The Contractor shall verify the location and depth of all services prior to commencing on site.  
3. The Contractor shall be liable for any damage to services during landscape works.  
4. The Contractor shall verify the location of any existing trees shown to be retained and protect them during works.  
5. All trees shall be planted in locations shown on the plan.  
6. Any change to plant species must have the approval of the Landscape Architect.  
7. Trees shall be planted no less than the following distances from landscape elements:  
Footpaths: 1.2m  
Stormwater & sewerage pits: 1.5m  
Service crossings: 1.5m  
Street lights or signs: 2.0m  
Driveways and crossings: 2.5m  
Intersections: 10.0m  
Kerb & channel: 1.2m  
8. Construction certification for all structural elements is to be provided prior to practical completion being granted.

## DRAWING SCHEDULE

dwg #	dwg title	Revision
L000	Cover Sheet	A
L100	Landscape Plans 01	A
L101	Landscape Plans 02	A
L102	Landscape Plans 03	A
L103	Landscape Plans 04	A
L104	Landscape Plans 05	A
L200	Landscape Details	A

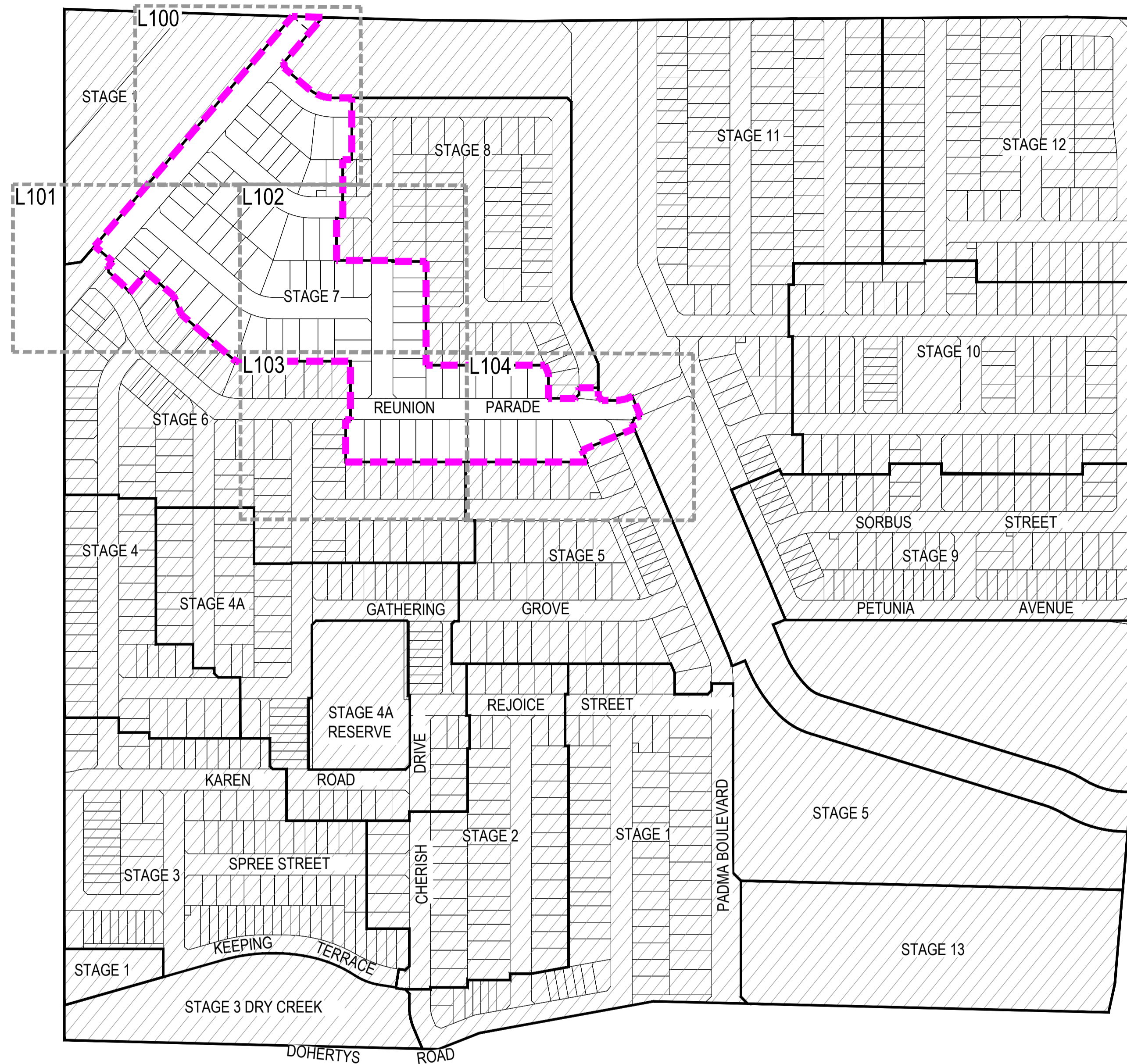

LOCATION PLAN N.T.S.

EXTENT OF WORKS

OTHER STAGES

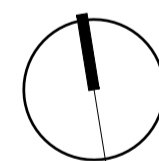

Revision	Description	Date	Drawn	Checked
A	ISSUE FOR BONDING	09.08.22	MK	BN

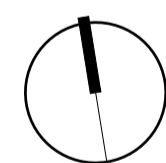

Scale (metres) NTS @ A1

**SMEC**  
Member of the Surbana Jurong Group  
SMC Australia Pty Ltd  
Tower 4, Level 20, 727 Collins Street  
Melbourne, VIC 3008, Australia  
(PO Box 28207, Docklands,  
VIC 3002, Australia)  
T +61 3 9514 1500 F +61 3 9514 1502  
E melbourne@smec.com  
www.smec.com

**Growland**  
**Marigold Estate**  
Stage 7 Streetscapes

Cover Sheet

Designed M.K. Drawn M.K.  
Checked B.N. Approved J.D.

Status For Approval

Date Aug-22 Scale NTS Sheet No. 1 of 7

Job No. 30042360L.07 Drawing No. L000 Revision A



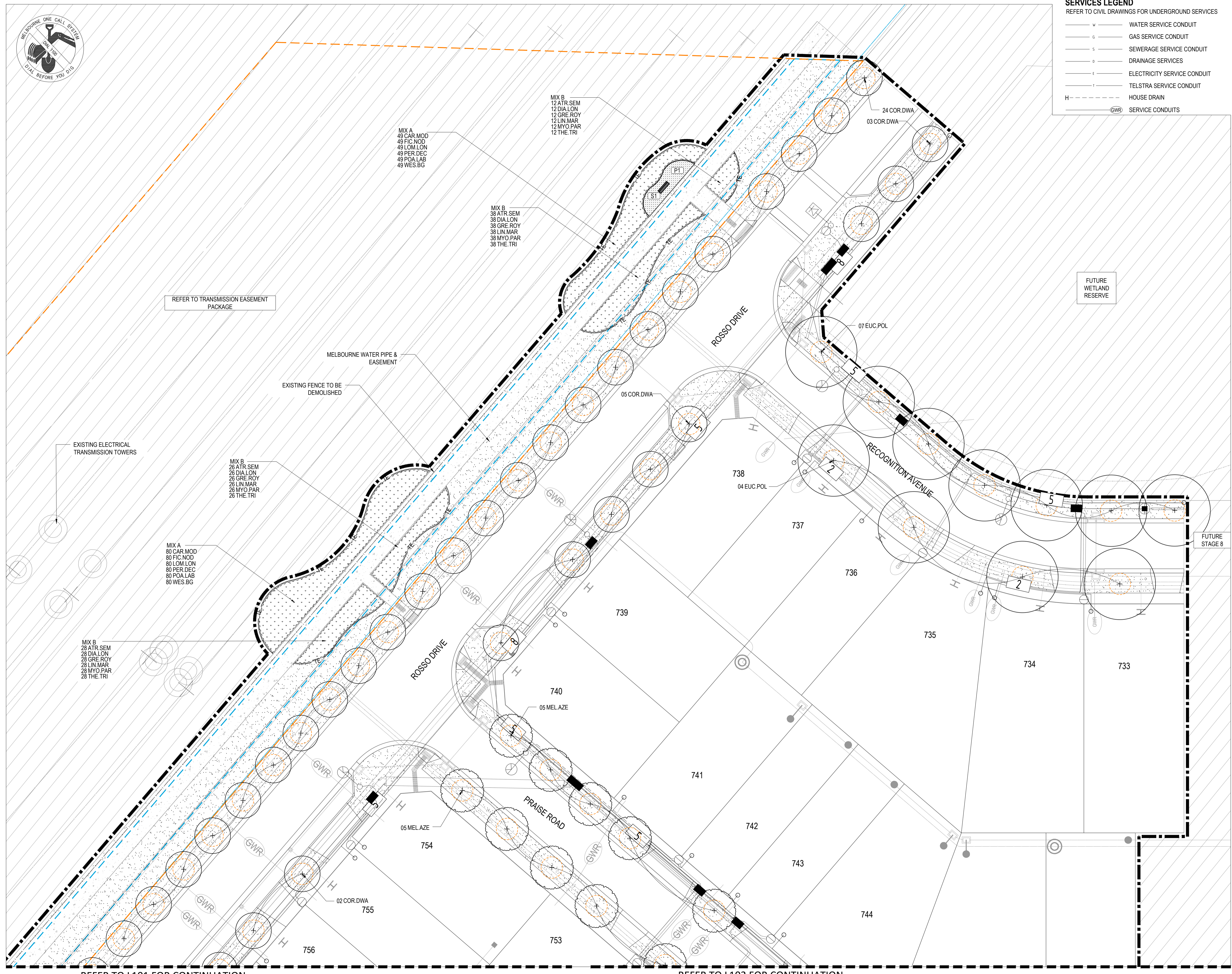

**SERVICES LEGEND**  
REFER TO CIVIL DRAWINGS FOR UNDERGROUND SERVICES

- W WATER SERVICE CONDUIT
- G GAS SERVICE CONDUIT
- S SEWERAGE SERVICE CONDUIT
- D DRAINAGE SERVICES
- E ELECTRICITY SERVICE CONDUIT
- T TELSTRA SERVICE CONDUIT
- H HOUSE DRAIN
- GWR SERVICE CONDUITS

**LEGEND**

- EXTENT OF WORKS BOUNDARY
- ELECTRICAL EASEMENT
- MELBOURNE WATER EASEMENT
- SERVICE OFFSET (3M DIAMETER)
- PROPOSED TREE (EVERGREEN) REFER PLANT SCHEDULE, DETAILS & SPECIFICATION
- SERVICE OFFSET (3M DIAMETER)
- PROPOSED TREE (DECIDUOUS) REFER PLANT SCHEDULE, DETAILS & SPECIFICATION
- PROPOSED TURF REFER DETAILS & SPECIFICATION
- MULCHED GARDEN BED REFER DETAILS & SPECIFICATION
- COMPACTED TUSCAN TOPPING REFER DETAILS & SPECIFICATION
- CONCRETE PATH BY CIVIL REFER DETAILS & SPECIFICATION
- TIMBER EDGE REFER DETAILS & SPECIFICATION
- SEATING REFER DETAILS & SPECIFICATION

**WARNING**  
**BWARE OF UNDERGROUND SERVICES**

Note that the location shown of existing underground services is indicative only and may not be accurate at the time of landscape works. No guarantee is given that all existing services are shown. Determination of the exact position and extent of underground services is the responsibility of the Contractor and is to be confirmed on site prior to commencement of work.

**GENERAL NOTES**

- Before commencement of works it is the responsibility of the Landscape Contractor to contact dial before you dig (ph. 1100 or web 1100.com.au) for information on services in the area shown on the plan.
- The Contractor shall verify the location and depth of all services prior to commencing on site.
- The Contractor shall be liable for any damage to services during landscape works.
- The Contractor shall verify the location of any existing trees shown to be retained and protect them during works.
- All trees shall be planted in locations shown on the plan.
- Any change to plant species must have the approval of the Landscape Architect.
- Trees shall be planted no less than the following distances from landscape elements:  
Footpaths: 1.2m      Driveways and crossings: 2.5m  
Stormwater & sewerage pits: 1.5m      Intersections: 10.0m  
Service crossings: 1.5m      Kerb & channel: 1.2m  
Street lights or signs: 2.0m
- Construction certification for all structural elements is to be provided prior to practical completion being granted.

Revision	Description	Date	Drawn	Checked
A	ISSUE FOR BONDING	09.08.22	MK	BN



**SMEC**  
Member of the Surbana Jurong Group

SMEC Australia Pty Ltd  
Tower 4, Level 20, 727 Collins Street  
Melbourne, VIC 3008, Australia  
(P.O. Box 28027, Docklands,  
VIC 3002, Australia)  
T +61 3 9514 1500 F +61 3 9514 1502  
E melbourne@smec.com  
www.smec.com

**Growland**  
**Marigold Estate**  
Stage 7 Streetscapes

Landscape Plans 01

Designed	M.K.	Drawn	M.K.
Checked	B.N.	Approved	J.D.
Status	For Approval		
Date	Aug-22	Scale	1:250
Sheet No.	2 of 7		Job No.
30042360L.07	Drawing No.	L100	Revision
			A

REFER TO L101 FOR CONTINUATION

REFER TO L102 FOR CONTINUATION



REFER TO L100 FOR CONTINUATION

- LEGEND**
- EXTENT OF WORKS BOUNDARY
  - ELECTRICAL EASEMENT
  - MELBOURNE WATER EASEMENT
  - SERVICE OFFSET (3M DIAMETER)
  - PROPOSED TREE (EVERGREEN)  
REFER PLANT SCHEDULE, DETAILS & SPECIFICATION
  - SERVICE OFFSET (3M DIAMETER)
  - PROPOSED TREE (DECIDUOUS)  
REFER PLANT SCHEDULE, DETAILS & SPECIFICATION
  - PROPOSED TURF  
REFER DETAILS & SPECIFICATION
  - MULCHED GARDEN BED  
REFER DETAILS & SPECIFICATION
  - COMPACTED TUSCAN TOPPING  
REFER DETAILS & SPECIFICATION
  - CONCRETE PATH BY CIVIL  
REFER DETAILS & SPECIFICATION
  - TIMBER EDGE  
REFER DETAILS & SPECIFICATION
  - SEATING  
REFER DETAILS & SPECIFICATION

REFER TO TRANSMISSION EASEMENT PACKAGE

EXISTING ROCK WALL TO BE RETAINED

MIX A  
47 CAR.MOD  
47 FIC.NOD  
47 LOM.LON  
47 PER.DEC  
47 POA.LAB  
47 WES.BG

MIX B  
30 ATR.SEM  
30 DIA.LON  
30 GRE.ROY  
30 LIN.MAR  
30 MYO.PAR  
30 THE.TRI

MIX B  
38 ATR.SEM  
38 DIA.LON  
38 GRE.ROY  
38 LIN.MAR  
38 MYO.PAR  
38 THE.TRI

ROSSO DRIVE

FLOCK STREET

REFER TO L102 FOR CONTINUATION

**WARNING**  
**BWARE OF UNDERGROUND SERVICES**

Note that the location shown of existing underground services is indicative only and may not be accurate at the time of landscape works. No guarantee is given that all existing services are shown. Determination of the exact position and extent of underground services is the responsibility of the Contractor and is to be confirmed on site prior to commencement of work.

**GENERAL NOTES**

- Before commencement of works it is the responsibility of the Landscape Contractor to contact dial before you dig (ph. 1100 or web 1100.com.au) for information on services in the area shown on the plan.
- The Contractor shall verify the location and depth of all services prior to commencing on site.
- The Contractor shall be liable for any damage to services during landscape works.
- The Contractor shall verify the location of any existing trees shown to be retained and protect them during works.
- All trees shall be planted in locations shown on the plan.
- Any change to plant species must have the approval of the Landscape Architect.
- Trees shall be planted no less than the following distances from landscape elements:  
Footpaths: 1.2m      Driveways and crossings: 2.5m  
Stormwater & sewerage pits: 1.5m      Intersections: 10.0m  
Service crossings: 1.5m      Kerb & channel: 1.2m  
Street lights or signs: 2.0m
- Construction certification for all structural elements is to be provided prior to practical completion being granted.

Revision	Description	Date	Drawn	Checked
A	ISSUE FOR BONDING	09.08.22	MK	BN



**SMEC**  
Member of the Surlana Jorong Group

SMEC Australia Pty Ltd  
Tower 4, Level 20, 727 Collins Street  
Melbourne, VIC 3008, Australia  
(P.O. Box 2827, Docklands, VIC 3002, Australia)  
T +61 3 9514 1500 F +61 3 9514 1502  
E melbourne@smec.com  
www.smec.com

**Growland**  
**Marigold Estate**  
Stage 7 Streetscapes

Landscape Plans 02

Designed M.K.      Drawn M.K.  
Checked B.N.      Approved J.D.

Status For Approval

Date Aug-22      Scale 1:250      Sheet No. 3 of 7

Job No. 30042360L.07      Drawing No. L101      Revision A

- SERVICES LEGEND**  
REFER TO CIVIL DRAWINGS FOR UNDERGROUND SERVICES
- WATER SERVICE CONDUIT
  - GAS SERVICE CONDUIT
  - SEWERAGE SERVICE CONDUIT
  - DRAINAGE SERVICES
  - ELECTRICITY SERVICE CONDUIT
  - TELSTRA SERVICE CONDUIT
  - HOUSE DRAIN
  - SERVICE CONDUITS





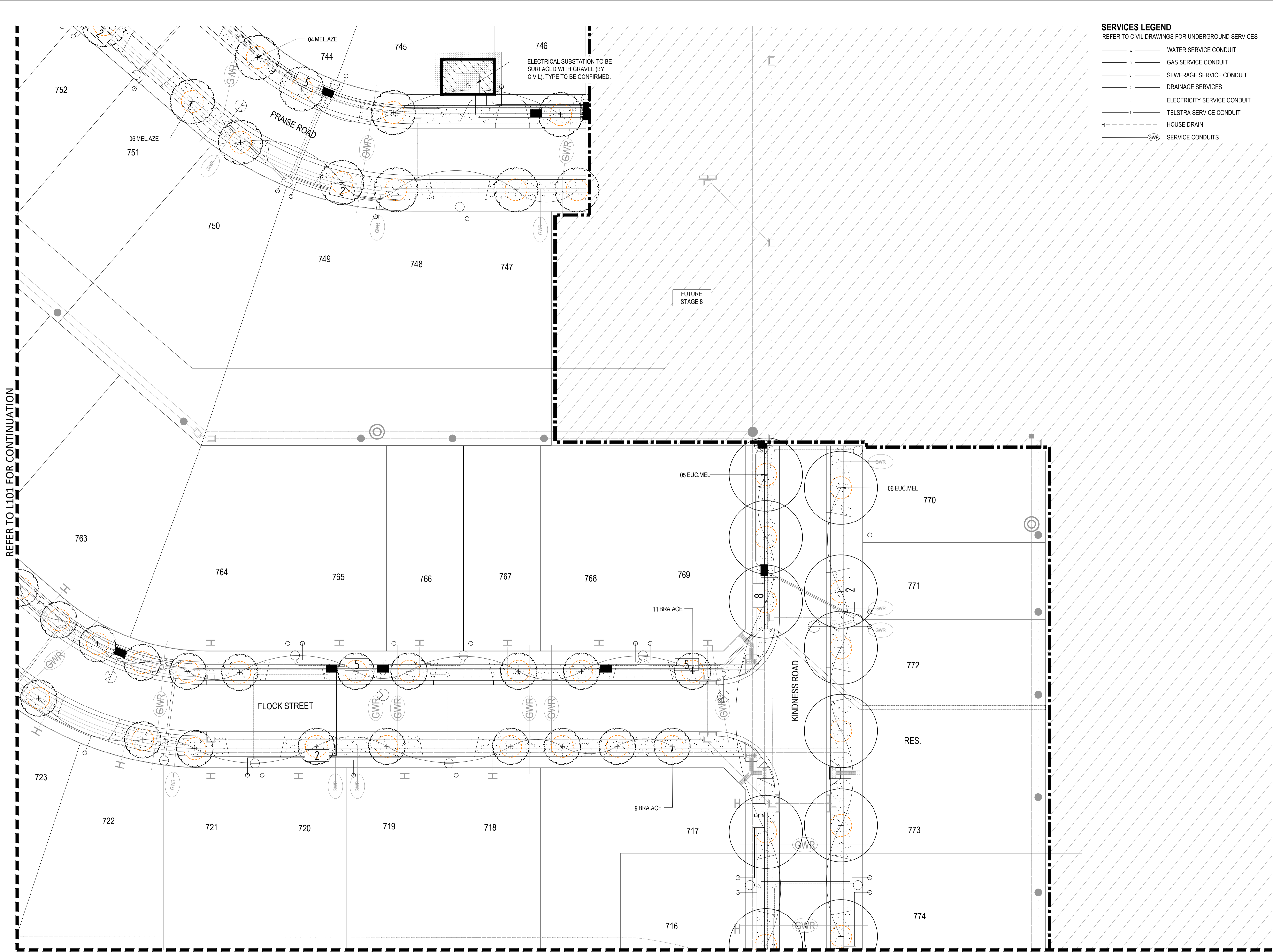

**SERVICES LEGEND**  
 REFER TO CIVIL DRAWINGS FOR UNDERGROUND SERVICES

- w — WATER SERVICE CONDUIT
- g — GAS SERVICE CONDUIT
- s — SEWERAGE SERVICE CONDUIT
- o — DRAINAGE SERVICES
- e — ELECTRICITY SERVICE CONDUIT
- t — TELSTRA SERVICE CONDUIT
- H — HOUSE DRAIN
- GWR — SERVICE CONDUITS

**LEGEND**

- — — — — EXTENT OF WORKS BOUNDARY
- — — — — ELECTRICAL EASEMENT
- — — — — MELBOURNE WATER EASEMENT
- + ○ SERVICE OFFSET (3M DIAMETER)  
 ○ + ○ PROPOSED TREE (EVERGREEN)  
 REFER PLANT SCHEDULE, DETAILS & SPECIFICATION
- + ○ SERVICE OFFSET (3M DIAMETER)  
 ○ + ○ PROPOSED TREE (DECIDUOUS)  
 REFER PLANT SCHEDULE, DETAILS & SPECIFICATION
- PROPOSED TURF  
 REFER DETAILS & SPECIFICATION
- MULCHED GARDEN BED  
 REFER DETAILS & SPECIFICATION
- [PT] COMPACTED TUSCAN TOPPING  
 REFER DETAILS & SPECIFICATION
- CONCRETE PATH BY CIVIL  
 REFER DETAILS & SPECIFICATION
- TE — TIMBER EDGE  
 REFER DETAILS & SPECIFICATION
- [S1] SEATING  
 REFER DETAILS & SPECIFICATION

**WARNING**  
**BEWARE OF UNDERGROUND SERVICES**

Note that the location shown of existing underground services is indicative only and may not be accurate at the time of landscape works. No guarantee is given that all existing services are shown. Determination of the exact position and extent of underground services is the responsibility of the Contractor and is to be confirmed on site prior to commencement of work.

- GENERAL NOTES**
- Before commencement of works it is the responsibility of the Landscape Contractor to contact dial before you dig (ph. 1100 or web 1100.com.au) for information on services in the area shown on the plan.
  - The Contractor shall verify the location and depth of all services prior to commencing on site.
  - The Contractor shall be liable for any damage to existing trees during landscape works.
  - The Contractor shall verify the location of any existing trees shown to be retained and protect them during works.
  - All trees shall be planted in locations shown on the plan.
  - Any change to plant species must have the approval of the Landscape Architect.
  - Trees shall be planted no less than the following distances from landscape elements:  
 Footpaths: 1.2m  
 Stormwater & sewerage pits: 1.5m  
 Service crossings: 1.5m  
 Street lights or signs: 2.0m  
 Driveways and crossings: 2.5m  
 Intersections: 10.0m  
 Kerb & channel: 1.2m
  - Construction certification for all structural elements is to be provided prior to practical completion being granted.

Revision	Description	Date	Drawn	Checked
A	ISSUE FOR BONDING	09.08.22	MK	BN



**SMEC**  
 Member of the Surlana Jurong Group

SMEC Australia Pty Ltd  
 Tower 4, Level 20, 727 Collins Street  
 Melbourne, VIC 3008, Australia  
 (P.O. Box 28207, Docklands,  
 VIC 3002, Australia)  
 T +61 3 9514 1500 F +61 3 9514 1502  
 E melbourne@smec.com  
 www.smec.com

**Growland**  
**Marigold Estate**  
 Stage 7 Streetscapes

Landscape Plans 03

Designed	M.K.	Drawn	M.K.
Checked	B.N.	Approved	J.D.
Status	For Approval		
Date	Aug-22	Scale	1:250
Job No.	30042360L.07	Sheet No.	4 of 7
Drawing No.	L102	Revision	A



REFER TO L101 FOR CONTINUATION

REFER TO L103 FOR CONTINUATION



REFER TO L102 FOR CONTINUATION

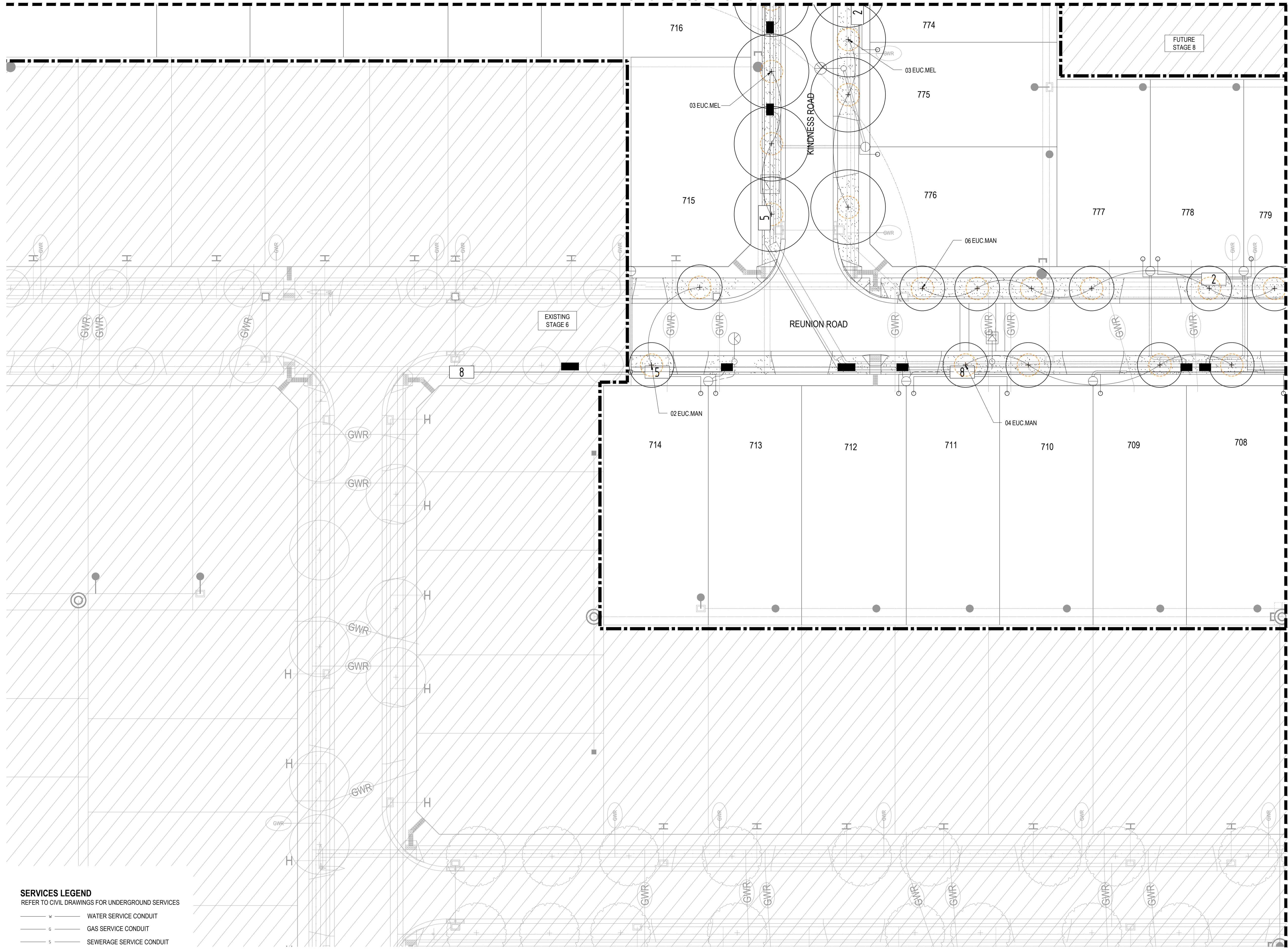

**LEGEND**

- EXTENT OF WORKS BOUNDARY
- ELECTRICAL EASEMENT
- MELBOURNE WATER EASEMENT
- SERVICE OFFSET (3M DIAMETER)
- PROPOSED TREE (EVERGREEN)
- SERVICE OFFSET (3M DIAMETER)
- PROPOSED TREE (DECIDUOUS)
- PROPOSED TURF
- MULCHED GARDEN BED
- COMPACTED TUSCAN TOPPING
- CONCRETE PATH BY CIVIL
- TIMBER EDGE
- SEATING

**WARNING**  
**BWARE OF UNDERGROUND SERVICES**  
 Note that the location shown of existing underground services is indicative only and may not be accurate at the time of landscape works. No guarantee is given that all existing services are shown. Determination of the exact position and extent of underground services is the responsibility of the Contractor and is to be confirmed on site prior to commencement of work.

**GENERAL NOTES**

- Before commencement of works it is the responsibility of the Landscape Contractor to contact dial before you dig (ph. 1100 or web 1100.com.au) for information on services in the area shown on the plan.
- The Contractor shall verify the location and depth of all services prior to commencing on site.
- The Contractor shall be liable for any damage to services during landscape works.
- The Contractor shall verify the location of any existing trees shown to be retained and protect them during works.
- All trees shall be planted in locations shown on the plan.
- Any change to plant species must have the approval of the Landscape Architect.
- Trees shall be planted no less than the following distances from landscape elements:  
 Footpaths: 1.2m  
 Stormwater & sewerage pits: 1.5m  
 Service crossings: 1.5m  
 Street lights or signs: 2.0m
- Construction certification for all structural elements is to be provided prior to practical completion being granted.

Revision	Description	Date	Drawn	Checked
A	ISSUE FOR BONDING	09.08.22	MK	BN



**SMEC**  
 Member of the Surbana Jurong Group

SMEC Australia Pty Ltd  
 Tower 4, Level 20, 727 Collins Street  
 Melbourne, VIC 3008, Australia  
 PO Box 28271, Docklands,  
 VIC 3002, Australia  
 T +61 3 9514 1500 F +61 3 9514 1502  
 E melbourne@smec.com  
 www.smec.com

**Growland**  
**Marigold Estate**  
 Stage 7 Streetscapes

Landscape Plans 04

Designed	M.K.	Drawn	M.K.
Checked	B.N.	Approved	J.D.
Status	For Approval		
Date	Aug-22	Scale	1:250
Job No.	30042360L.07	Sheet No.	5 of 7
Drawing No.	L103	Revision	A

**SERVICES LEGEND**  
 REFER TO CIVIL DRAWINGS FOR UNDERGROUND SERVICES

- WATER SERVICE CONDUIT
- GAS SERVICE CONDUIT
- SEWERAGE SERVICE CONDUIT
- DRAINAGE SERVICES
- ELECTRICITY SERVICE CONDUIT
- TELSTRA SERVICE CONDUIT
- HOUSE DRAIN
- SERVICE CONDUITS





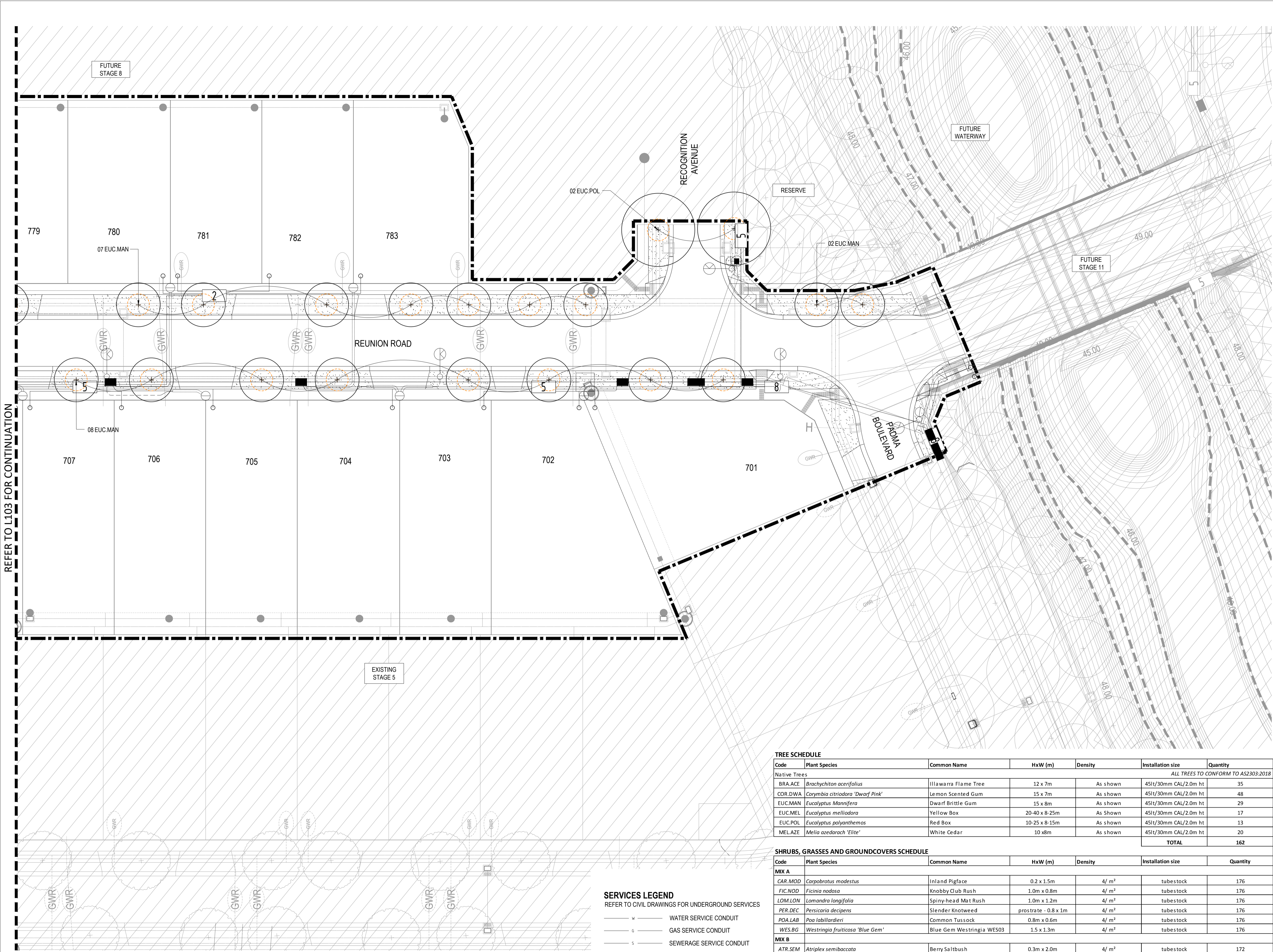

**LEGEND**

- EXTENT OF WORKS BOUNDARY
- ELECTRICAL EASEMENT
- MELBOURNE WATER EASEMENT
- SERVICE OFFSET (3M DIAMETER)
- PROPOSED TREE (EVERGREEN)  
REFER PLANT SCHEDULE, DETAILS & SPECIFICATION
- SERVICE OFFSET (3M DIAMETER)
- PROPOSED TREE (DECIDUOUS)  
REFER PLANT SCHEDULE, DETAILS & SPECIFICATION
- PROPOSED TURF  
REFER DETAILS & SPECIFICATION
- MULCHED GARDEN BED  
REFER DETAILS & SPECIFICATION
- COMPACTED TUSCAN TOPPING  
REFER DETAILS & SPECIFICATION
- CONCRETE PATH BY CIVIL  
REFER DETAILS & SPECIFICATION
- TIMBER EDGE  
REFER DETAILS & SPECIFICATION
- SEATING  
REFER DETAILS & SPECIFICATION

**WARNING**  
**BEWARE OF UNDERGROUND SERVICES**  
 Note that the location shown of existing underground services is indicative only and may not be accurate at the time of landscape works. No guarantee is given that all existing services are shown. Determination of the exact position and extent of underground services is the responsibility of the Contractor and is to be confirmed on site prior to commencement of work.

- GENERAL NOTES**
1. Before commencement of works it is the responsibility of the Landscape Contractor to contact dial before you dig (ph. 1100 or web 1100.com.au) for information on services in the area shown on the plan.
  2. The Contractor shall verify the location and depth of all services prior to commencing on site.
  3. The Contractor shall be liable for any damage to services during landscape works.
  4. The Contractor shall verify the location of any existing trees shown to be retained and protect them during works.
  5. All trees shall be planted in locations shown on the plan.
  6. Any change to plant species must have the approval of the Landscape Architect.
  7. Trees shall be planted no less than the following distances from landscape elements:  
 Footpaths: 1.2m  
 Stormwater & sewerage pits: 1.5m  
 Service crossings: 1.5m  
 Street lights or signs: 2.0m
  8. Construction certification for all structural elements is to be provided prior to practical completion being granted.

REFER TO L103 FOR CONTINUATION

A	ISSUE FOR BONDING	09.08.22	MK	BN
Revision	Description	Date	Drawn	Checked



**TREE SCHEDULE**

Code	Plant Species	Common Name	HxW (m)	Density	Installation size	Quantity
Native Trees						
<i>ALL TREES TO CONFORM TO AS2303:2018</i>						
BRA.ACE	<i>Brachycton acerifolius</i>	Illawarra Flame Tree	12 x 7m	As shown	45lt/30mm CAL/2.0m ht	35
COR.DWA	<i>Corymbia citriodora 'Dwarf Pink'</i>	Lemon Scented Gum	15 x 7m	As shown	45lt/30mm CAL/2.0m ht	48
EUC.MAN	<i>Eucalyptus Mannifera</i>	Dwarf Brittle Gum	15 x 8m	As shown	45lt/30mm CAL/2.0m ht	29
EUC.MEL	<i>Eucalyptus melliodora</i>	Yellow Box	20-40 x 8-25m	As shown	45lt/30mm CAL/2.0m ht	17
EUC.POL	<i>Eucalyptus polyanthemus</i>	Red Box	10-25 x 8-15m	As shown	45lt/30mm CAL/2.0m ht	13
MEL.AZE	<i>Melia azedarach 'Elite'</i>	White Cedar	10 x 8m	As shown	45lt/30mm CAL/2.0m ht	20
<b>TOTAL</b>						<b>162</b>

**SHRUBS, GRASSES AND GROUNDCOVERS SCHEDULE**

Code	Plant Species	Common Name	HxW (m)	Density	Installation size	Quantity
<b>MIX A</b>						
CAR.MOD	<i>Carpobrotus modestus</i>	Inland Pigface	0.2 x 1.5m	4/ m <sup>2</sup>	tubestock	176
FIC.NOD	<i>Ficinia nodosa</i>	Knobby Club Rush	1.0m x 0.8m	4/ m <sup>2</sup>	tubestock	176
LON.LON	<i>Lomandra longifolia</i>	Spiny-head Mat Rush	1.0m x 1.2m	4/ m <sup>2</sup>	tubestock	176
PER.DEC	<i>Persicaria decipiens</i>	Slender Knotweed	prostrate - 0.8 x 1m	4/ m <sup>2</sup>	tubestock	176
POA.LAB	<i>Poa labillardieri</i>	Common Tussock	0.8m x 0.6m	4/ m <sup>2</sup>	tubestock	176
WES.BG	<i>Westringia fruticosa 'Blue Gem'</i>	Blue Gem Westringia WES03	1.5 x 1.3m	4/ m <sup>2</sup>	tubestock	176
<b>MIX B</b>						
ATR.SEM	<i>Atriplex semibaccata</i>	Berry Saltbush	0.3m x 2.0m	4/ m <sup>2</sup>	tubestock	172
DIA.LON	<i>Dianella longifolia</i>	Pale Flax-lily	0.6m x 0.5m	4/ m <sup>2</sup>	tubestock	172
GRE.ROY	<i>Grevillea 'Royal Rambler'</i>	Royal Rambler' Grevillea	0.3 x 2.5m	4/ m <sup>2</sup>	tubestock	172
LIN.MAR	<i>Linum marginale</i>	Native Flax	0.5m x 0.3m	4/ m <sup>2</sup>	tubestock	172
MYO.PAR	<i>Myoporum parvifolium 'Yareena'</i>	Creeping Boobialla	0.2 x 1.5m	4/ m <sup>2</sup>	tubestock	172
THE.TRI	<i>Themeda triandra</i>	Kangaroo Grass	1.0m x 0.5m	4/ m <sup>2</sup>	tubestock	172
<b>TOTAL</b>						<b>2088</b>

**SERVICES LEGEND**  
 REFER TO CIVIL DRAWINGS FOR UNDERGROUND SERVICES

- WATER SERVICE CONDUIT
- GAS SERVICE CONDUIT
- SEWERAGE SERVICE CONDUIT
- DRAINAGE SERVICES
- ELECTRICITY SERVICE CONDUIT
- TELSTRA SERVICE CONDUIT
- HOUSE DRAIN
- SERVICE CONDUITS



**SMEC**  
 Member of the Surlana Jurgon Group

Tower 4, Level 20, 727 Collins Street  
 Melbourne, VIC 3008, Australia  
 PO Box 28027, Docklands,  
 VIC 3002, Australia  
 T +61 3 9514 1500 F +61 3 9514 1502  
 E melbourne@smec.com  
 www.smec.com

**Growland**  
**Marigold Estate**  
 Stage 7 Streetscapes

Landscape Plans 05

Designed M.K. Drawn M.K.  
 Checked B.N. Approved J.D.

Status For Approval

Date Aug-22 Scale 1:250 Sheet No. 6 of 7

Job No. 30042360L.07 Drawing No. L104 Revision A



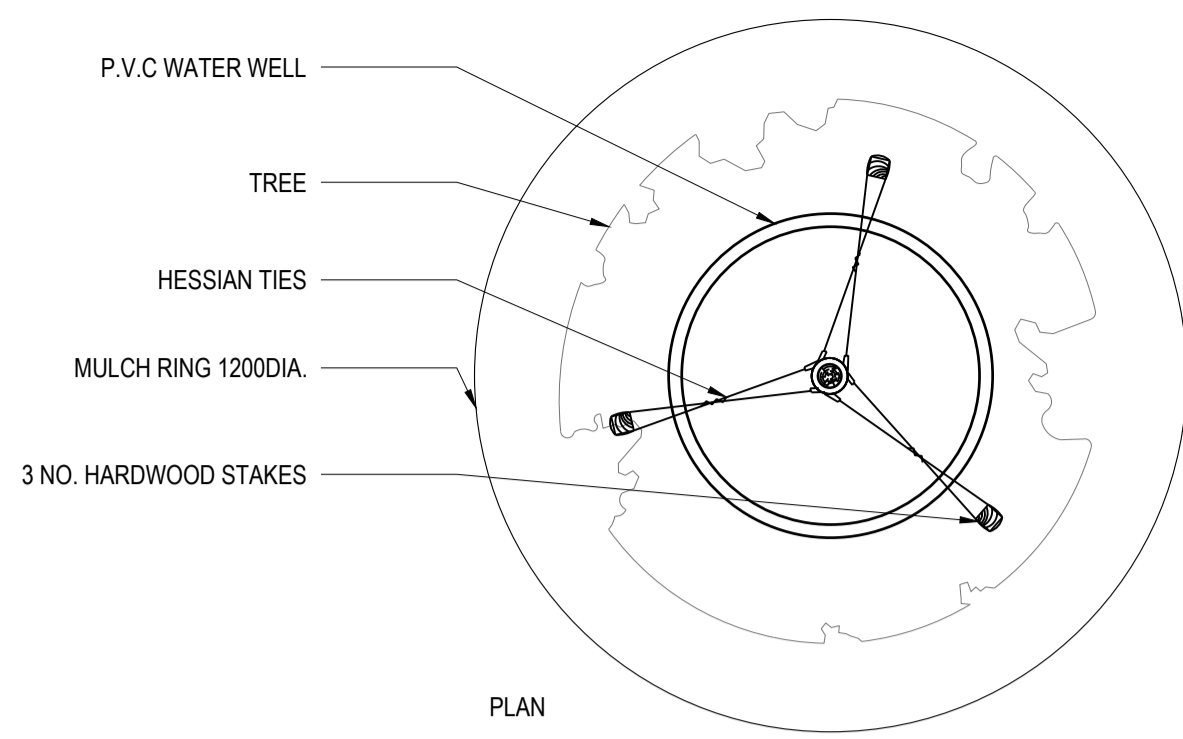

NOTE: IT IS THE RESPONSIBILITY OF THE CONTRACTOR TO CONFIRM THE LOCATION OF ALL UNDERGROUND SERVICES PRIOR TO COMMENCEMENT OF ANY EXCAVATION OR STAKING WORKS.

NOTE: TREE WATERING 1: 1ST INITIAL WATERING AT THE TIME OF PLANTING, POTABLE WATER IS TO BE MIXED WITH "GARRETT" JUICE OR ANOTHER WCC APPROVED ROOT PROMOTER PRODUCT AT APPROPRIATE RATES. ALL SUBSEQUENT WATERING OF TREES POST PLANTING - PROVIDE A MIN. 15LTS OF WATER OF APPROVED QUALITY MIXED WITH "SEASON" OR ANOTHER WCC APPROVED LIQUID SEA WEEED PRODUCT AT APPROPRIATE RATES. WATER IS TO BE DELIVERED INSIDE THE WATERWELL AT A RATE APPLICABLE SO AS NOT TO DISTURB MULCH.

NOTE: STRONG CENTRAL LEADING TRUNK TO BE EVIDENT AT TIME OF PLANTING

ALL TREES SUPPLIED MUST MEET THE CRITERIA OF AS2303-2018: TREE STOCK FOR LANDSCAPE USE & BE HEALTHY SPECIMENS FREE OF PESTS AND DISEASES. TREES TO BE WELL WATERED OF A MAXIMUM OF 24 HOURS PRIOR TO PLANTING

SET 3 OF 38X38X2400MM HARDWOOD STAKES VERTICALLY AND CLEAR OF ROOT BALL AND CANOPY AT 900MM SPACING, OFFSET A MIN. 200MM FROM UNDERGROUND SERVICES TO ENSURE NO DAMAGE IS CAUSED TO SERVICES. STAKES MUST BE POSITIONED SO AS TO PREVENT DAMAGE TO STRUCTURAL BRANCHES AND PREVENT RUBBING ON BRANCHES.

50MM WIDE HESSIAN TIES OF GOOD QUALITY WRAPPED AROUND THE TRUNK AND NAILED OR STAPLED TO THE STAKE. TREE TIE IS TO BE POSITIONED AS HIGH AS POSSIBLE, LOOPED AROUND THE TRUNK AND NOT THE BRANCHES, AND BE LOOSE, HOWEVER STILL BE TIGHT ENOUGH TO PREVENT EXCESSIVE MOVEMENT

POSITION TREE IN HOLE WITH THE TOP OF THE ROOTBALL AT THE SAME HEIGHT AS THE SURROUNDING GROUND AND BACKFILL WITH 50/50 BLEND OF SITE SOIL AND IMPORTED ORGANIC TOPSOIL. IMPORTED ORGANIC TOPSOIL MUST BE AS PER AS:4419 2003: SOILS FOR LANDSCAPE & GARDENS.

AT THE TIME OF PLANTING, IF THE ROOTS ARE MATTED, SLICE THE BOTTOM 50MM OFF AND APPLY THE SPADE TO THE BOTTOM IN EACH QUADRANT.

POSITION P.V.C. WATER WELL WITH THE TOP OF THE WATER WELL NO GREATER THAN 150MM ABOVE G.L. AND IN STRAIGHT POSITION PARALLEL TO THE NATURESTRIP

APPLY AND SPREAD WCC APPROVED RAW COARSE MULCH (AS PER AS4454-2012) TO A DEPTH OF 150MM AND 1200MM DIAMETER FROM TREE

APPLY 500GMS OF GYPSUM TO THE PLANTING SITE AT A RADIUS OF A MINIMUM 1200MM DIAMETER FROM CENTRE OF HOLE

APPLY WCC APPROVED RAW COARSE MULCH (AS PER AS4454-2012) TO 25MM DEPTH INSIDE THE WATER WELL. NO MULCH IS TO BE TOUCHING THE TREE.

APPLY 500gms OF GYPSUM TO INSIDE OF HOLE. LIGHTLY COMPACT SOIL AT THE BASE TO PREVENT SETTLING.

EXCAVATE A PLANTING HOLE WITH SLOPING SIDES 3 TIMES THE WIDTH OF THE ROOTBALL. BREAK UP SIDES AND BASE. IF DIGGING IN SOIL OF LOW PERMEABILITY, THE HOLE SHOULD BE WIDER AND DEEPER. IN THIS INSTANCE BACKFILL WILL BE REQUIRED AT BASE OF HOLE. AUGERS ARE NOT TO BE USED FOR EXCAVATION OF THE PLANTING HOLE. PLANTING HOLE IS TO BE WATERED PRIOR TO PLANTING. NO TREE IS TO BE PLANTED INTO NATURALLY WATERLOGGED SOIL. IF SOIL IS WATERLOGGED, PLANTING MUST BE RESCHEDULED TO ALLOW SUFFICIENT TIME FOR THE SOIL TO DRY OUT.

1 TYPICAL ADVANCE TREE PLANTING DETAIL (3 STAKES) SCALE 1:20

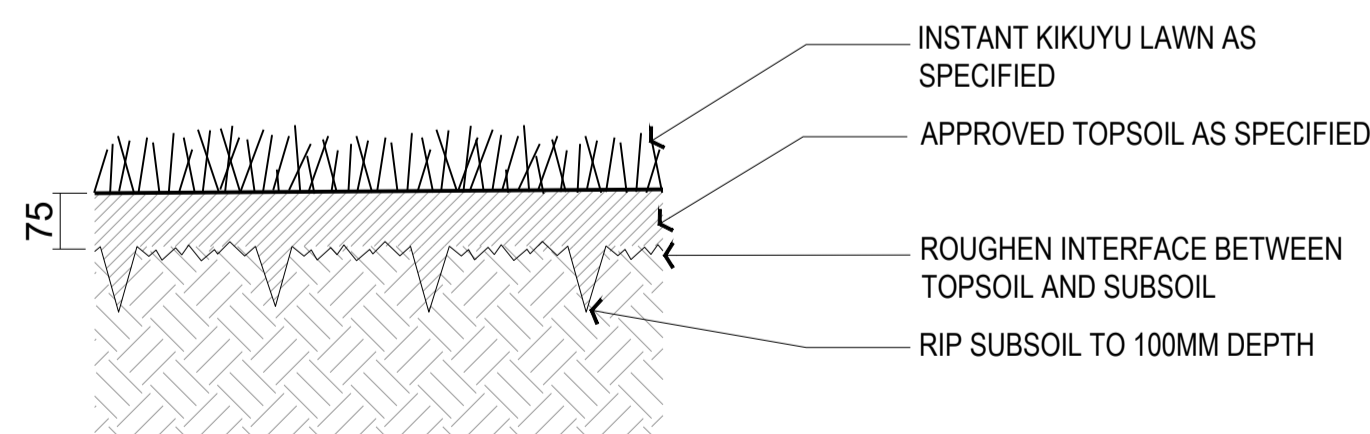

2 TYPICAL TURF DETAIL SCALE 1:10

3 TYPICAL TUBESTOCK PLANTING DETAIL SCALE 1:10

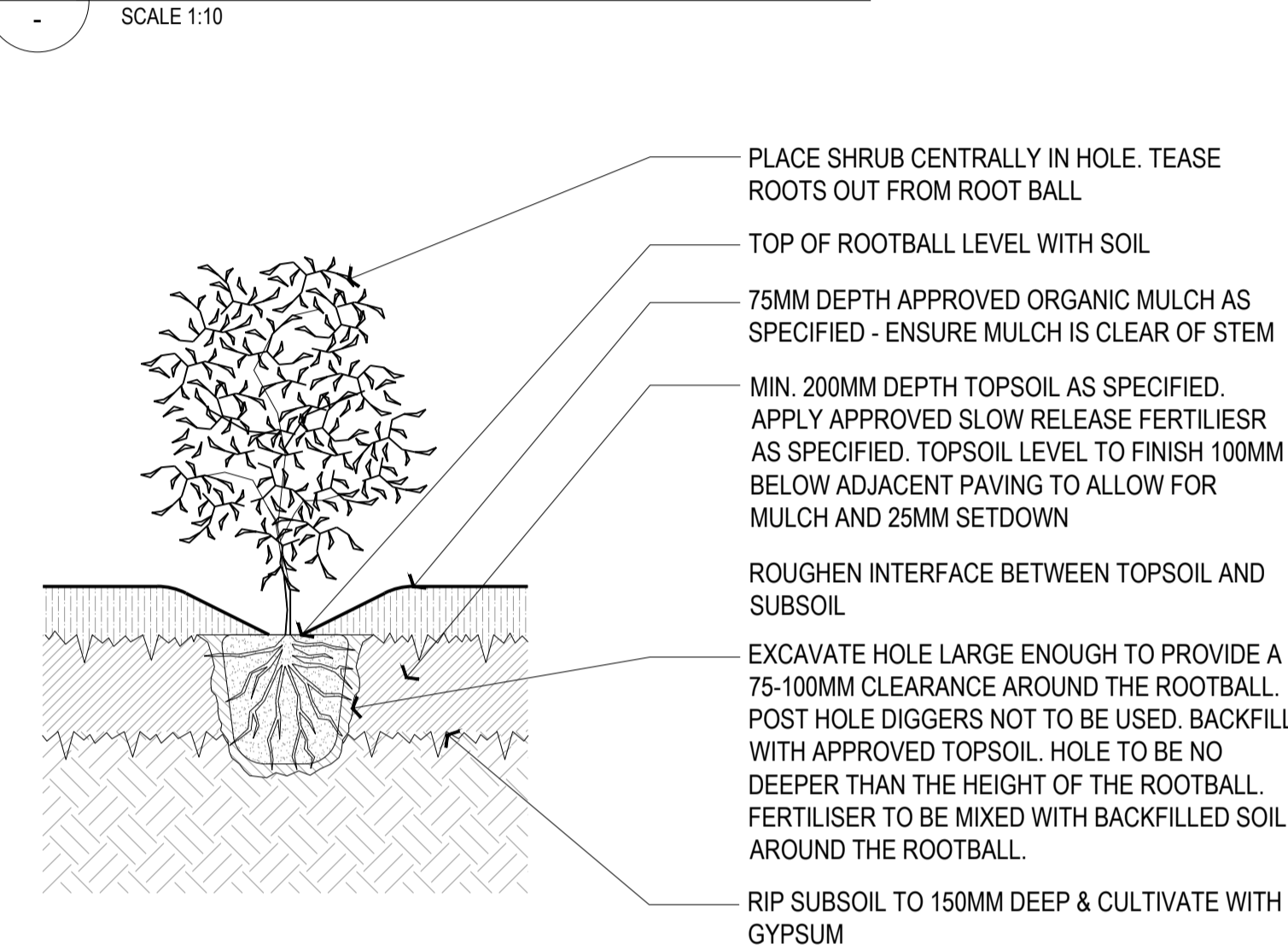

4 TYPICAL SHRUB PLANTING DETAIL SCALE 1:10

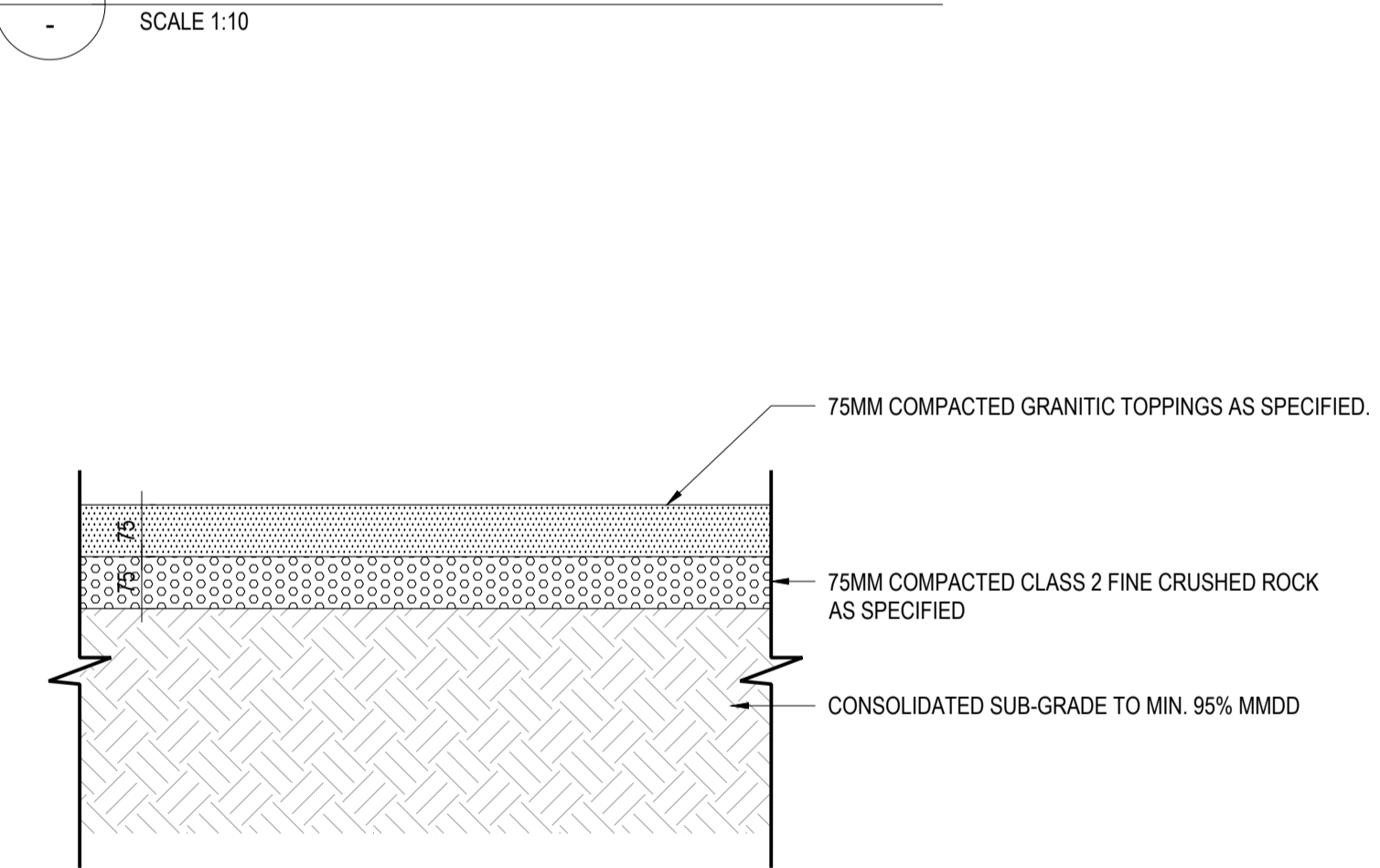

5 TYPICAL COMPACTED TUSCAN TOPPING DETAIL SCALE 1:10

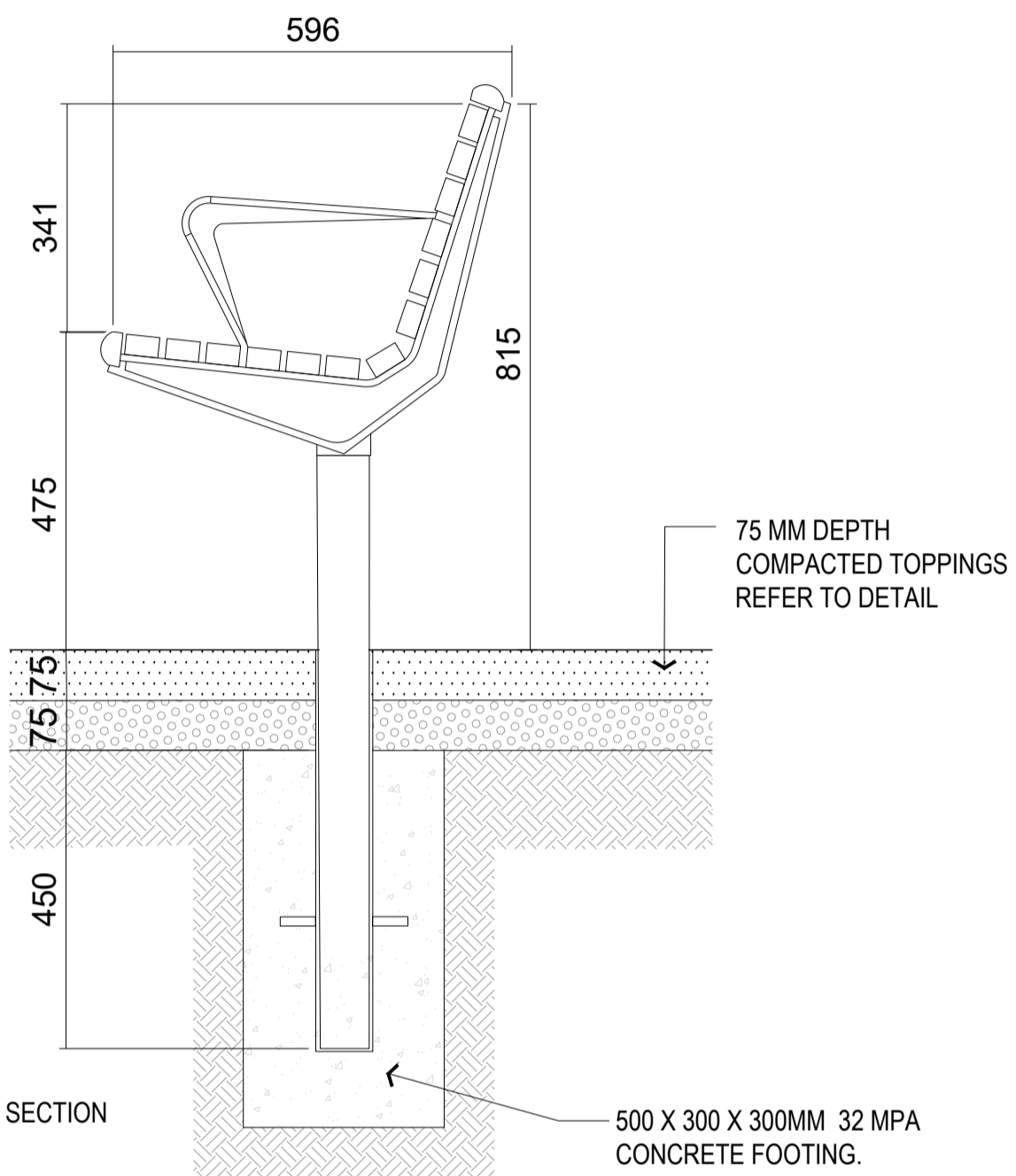
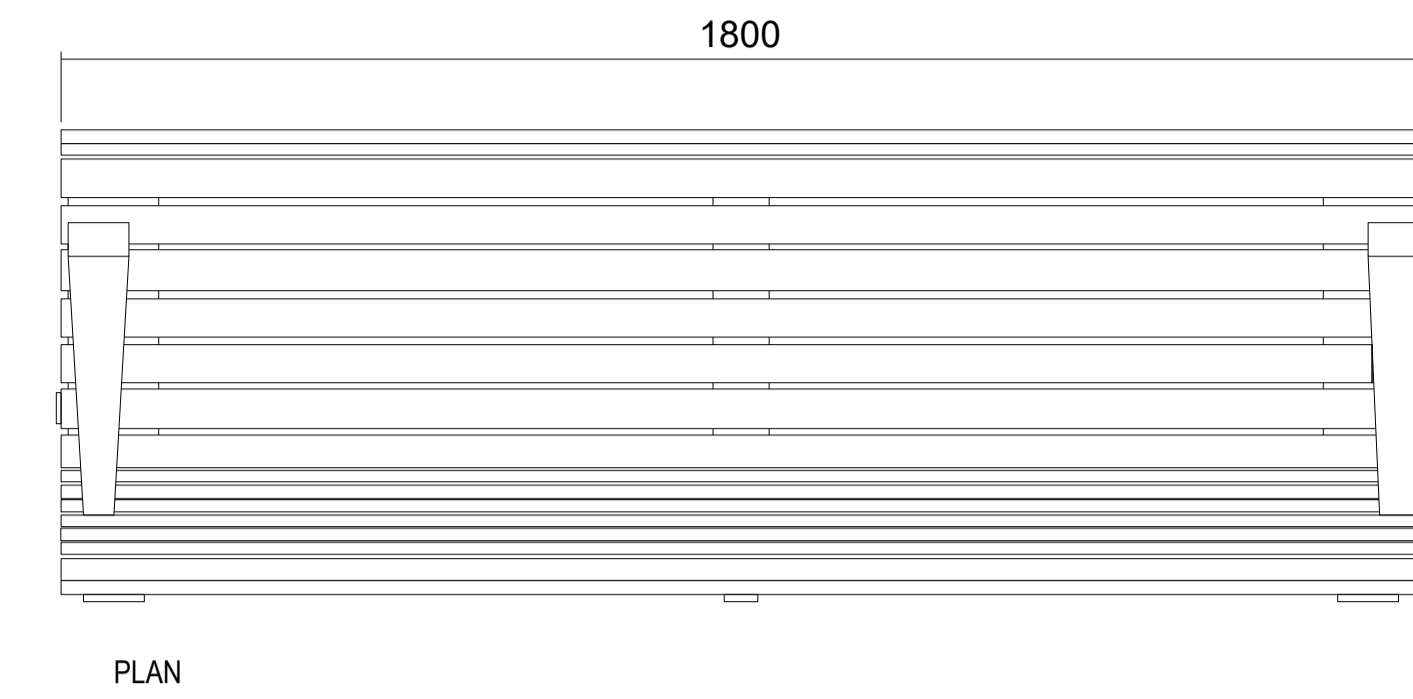

6 S1 - STANDARD SEAT PLAN AND SECTION SCALE 1:10

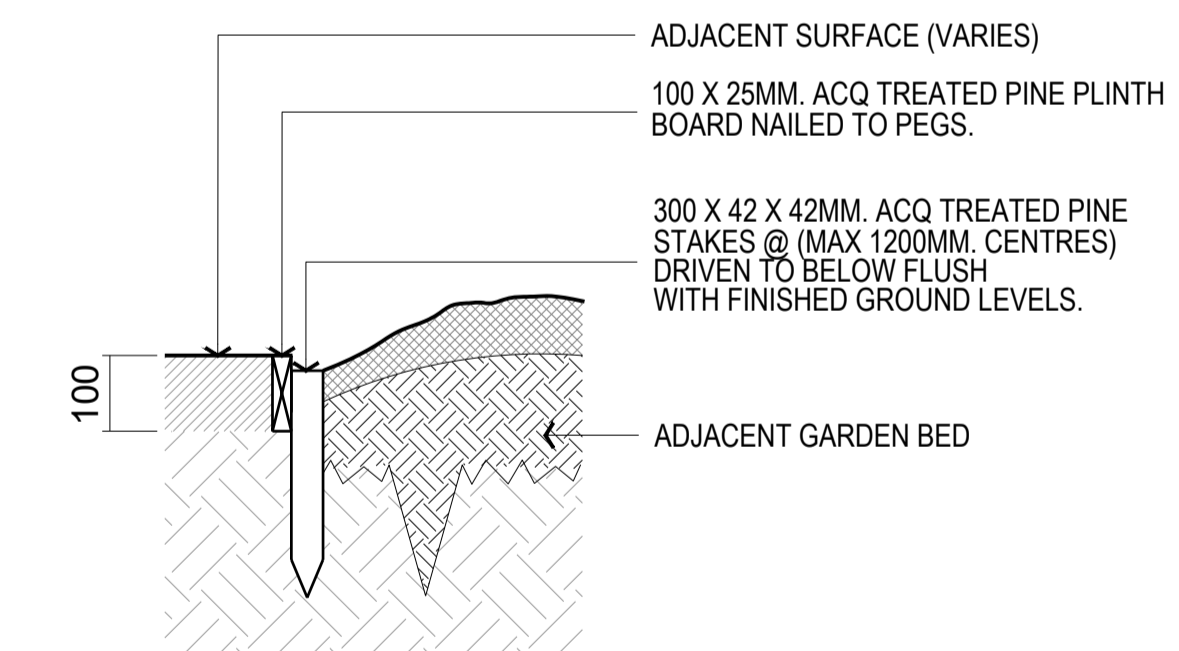

7 TYPICAL TIMBER EDGE DETAIL SCALE 1:10



**WARNING**  
BEWARE OF UNDERGROUND SERVICES  
Note that the location shown of existing underground services is indicative only and may not be accurate at the time of landscape works. No guarantee is given that all existing services are shown. Determination of the exact position and extent of underground services is the responsibility of the Contractor and is to be confirmed on site prior to commencement of work.

**GENERAL NOTES**

- Before commencement of works it is the responsibility of the Landscape Contractor to contact dial before you dig (ph. 1100 or web 1100.com.au) for information on services in the area shown on the plan.
- The Contractor shall verify the location and depth of all services prior to commencing on site.
- The Contractor shall be liable for any damage to services during landscape works.
- The Contractor shall verify the location of any existing trees shown to be retained and protect them during works.
- All trees shall be planted in locations shown on the plan.
- Any change to plant species must have the approval of the Landscape Architect.
- Trees shall be planted no less than the following distances from landscape elements:  
Footpaths: 1.2m  
Stormwater & sewerage pits: 1.5m  
Service crossings: 1.5m  
Street lights or signs: 2.0m
- Driveways and crossings: 2.5m  
Intersections: 10.0m  
Kerb & channel: 1.2m
- Construction certification for all structural elements is to be provided prior to practical completion being granted.

Revision	Description	Date	Drawn	Checked
A	ISSUE FOR BONDING	09.08.22	MK	BN

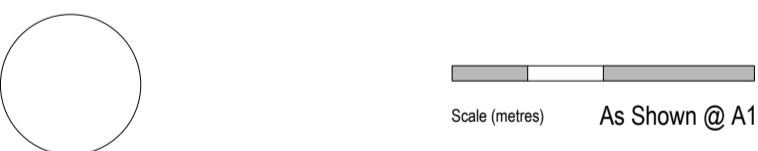

**SMEC**  
Member of the Surbana Jurong Group  
Tower 4, Level 20, 727 Collins Street  
Melbourne, VIC 3008, Australia  
PO Box 2027, Docklands,  
VIC 3002, Australia  
T +61 3 9514 1500 F +61 3 9514 1502  
E melbourne@smec.com  
www.smec.com

**Growland**  
**Marigold Estate**  
Stage 7 Streetscapes

Landscape Details

Designed	M.K.	Drawn	M.K.
Checked	B.N.	Approved	J.D.
Status	For Approval		
Date	Aug-22	Scale	As Shown
Job No.	30042360L.07	Sheet No.	7 of 7
Drawing No.	L200	Revision	A